

MERRILL

Known for
Service - Quality - Selection

OVER
3,000
NO LEAD
ITEMS

2016
2nd Edition

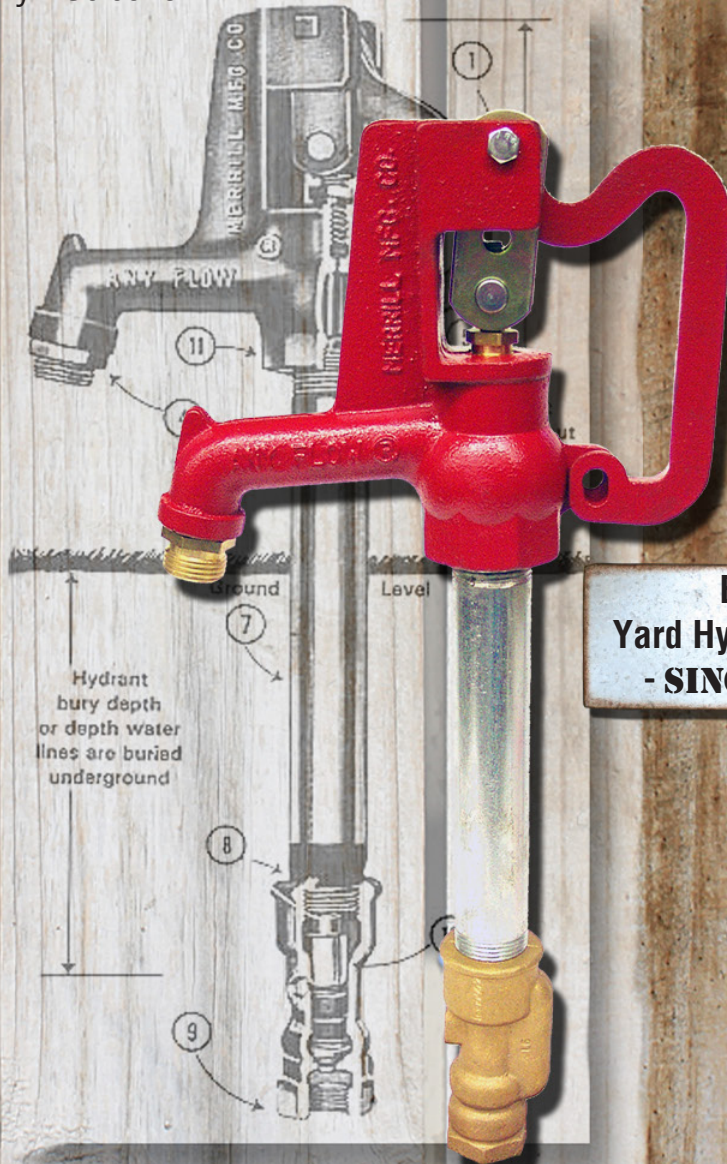

**BEST
Yard Hydrant Made
- SINCE 1949 -**

**MERRILL
MANUFACTURING CO.**

315 Flindt Drive
P.O. Box 392
Storm Lake, IA 50588-0392

1-800-831-6962
www.merrillmfg.com



PROUDLY MADE IN THE USA

MERRILL
MFG. TM



1

Frost Proof Yard Hydrants
Pages 8-38



2

Pitless Units, Kits, Adapters
Pages 39-61



3

Well Caps, Well Seals
Pages 62-66



4

Floats, Air Volume Controls
Pages 67-70



5

Tank Tees, Tee Kits, Tee Acc.
Pages 71-88



6

Pressure Switches & Gauges
Pages 89-96



7

Splice Kits, Torque Arrestors, Couplings
Pages 97-105



8

Well Points, Pump Rod, Cup Leathers
Pages 106-114



9

Insert Fittings & Clamps
Pages 115-129



10

Frost Proof Wall Faucets
Pages 130-131



11

Check & Foot Valves
Pages 132-143

A YARD HYDRANT FOR EVERYONE FROM



- Main/International No. (712) 732-2760
- U.S. and Canada No. (800) 831-6962
 - Fax No. (712) 732-4401
- U.S. Fax No. (800) ANY FLOW
- <http://www.merrillmfg.com>

GOOD

BETTER

BEST

B-7000 Series



Economy and Quality

No-Lead Available

E-5000 Series



Economy and Quality

Plastic/Metal Packing Gland
No-Lead Available

M-2000 Series



Only No-Lead Noncorrosive Hydrant

R-6000 Series



Easy To Operate High Flow Rate

No-Lead Available

C-1000 Series



High Quality Reasonable Price

Brass/Stainless Pipe, No-Lead and Hi-Capacity also Available

ANYFLOW Series



Highest Quality Most Benefits Built-In

Brass/Stainless Pipe
No-Lead also Available

SPECIALTY HYDRANTS FOR OTHER INSTALLATIONS

HI-CAPACITY Series



For High Flow Rate Demands
No-Lead Available

ANY TEMP / H-3000 Series



For Mfd. Homes or Heated Always On Applications
No-Lead

HIDE-DRANT



Removable Sanitary Yard Hydrant
No-Lead

Y-1 Series



Self-Closing For Public Areas
No-Lead

Y-2 Series



Self-Closing For Automatic Waterers
No-Lead

THE LARGEST SELECTION AND ONLY NAME YOU NEED TO KNOW FOR YARD HYDRANTS

#1 In The Industry

MERRILL

MFG.®

Known For
Service - Quality - Selection

Now #1 in Insert Fittings

#1

Standard
Male
Adapter
6 Insert
Barbs



Long
Male
Adapter
9 Insert
Barbs



Extra
Long Male
Adapter
12 Insert
Barbs



Full line of Insert Fittings available in NINE (9) materials
- poly - nylon - pvc - steel - yellow brass - no lead brass - red brass -
no lead bronze - and stainless steel with hex or round body



Yard Hydrants

#1



Pitless Units - Kits - Adapters

#1



Waterproof Splice Kits

#1



Tank Tees

#1



Proudly American Made in Iowa

Storm Lake, Iowa 50588

1-800-831-6962

www.merrillmfg.com

#1

Merrill Manufacturing Limited Warranty
To The Original Purchaser

Merrill Manufacturing Company (herein after called "Merrill") warrants the products manufactured by us to be free from functional defects for a period of **ONE YEAR** from the date of shipment by Merrill to the **ORIGINAL PURCHASER ONLY**. This warranty is applicable under normal use and service provided its products are installed, used and maintained in accordance with Merrill instructions, limitations issued by Merrill, and all applicable local codes. The obligation under this warranty is limited to replacing or repairing, without charge, any part manufactured by Merrill proven to be defective at the time of shipment. Immediate written notification must be given by the purchaser to Merrill upon discovery of alleged defect. The company retains the right to have the product returned freight prepaid to establish a claim. All warranty replacements or refunds will be issued to original purchaser only, unless specifically agreed to by Merrill.

This warranty does not cover or apply to any products or material supplied by but not manufactured by Merrill and is limited to actual warranty extended to Merrill by its supplier.

This warranty shall not apply if the product has been modified or altered in any way by others. Merrill will make no allowance for such alterations unless authorized in writing by the company prior to such alterations. In no event shall the company be liable for expenses necessary for the removal or reinstallation of any product supplied by Merrill, or for any damages to other property or equipment resulting from the removal or installation of such product.

The foregoing warranty is only applicable to manufactured products by Merrill and any previous agreements, representations or warranties, oral or written are hereby canceled. No other express or implied warranties shall apply, including but not limited to implied warranties of merchantability and fitness to a particular use.

Merrill's total responsibility for damages whether arising in contract or tort arising out of or relating to its performance or the products covered hereunder, shall be limited to the contract price of the product. In no event shall Merrill be liable for any incidental or consequential damages such as loss of profit, loss of use of production or other facilities or equipment or any expenses incurred in reliance on the company's equipment whether suffered by the buyer or a third party. In no event shall Merrill be liable for expenses necessary to remove or reinstall any product supplied by Merrill, or for any damages to other property or equipment resulting from any such removal or reinstallation, without written consent from Merrill for a specific installation prior to original installation. Nothing in this paragraph shall in any way be construed to affect the liability the company may have for personal injury of any third party. Damages resulting from improper storage, improper handling, freezing, improper installation, fire, or any act of God will not be considered by Merrill as its liability. Merrill will not assume any expense or liability for repairs or modifications made to its products outside its facilities, without a written consent. Equipment and accessories used with the company product and supplies by other manufacturers are not warranted. Any complaint, controversy, or claim arising out of or relating to this warranty, or the breach thereof, shall first be communicated to Merrill's home office in Storm Lake, Iowa.

Under no circumstances should Merrill frost proof yard hydrants be installed where the hydrant is allowed to drain into a water well or the drain water is allowed to come into contact with any drinking water supply. Merrill disclaims all liability of any kind and voids the hydrant warranty for installations of this product where it can or could drain back into a drinking water supply.

Merrill products are not designed or engineered for use in a nuclear facility, or in conjunction with any nuclear facility or support facility. Use of any Merrill products in any such applications is a misuse of these products and voids all warranties contained herein, expressed and implied, of merchantability and fitness for a particular purpose.

MERRILL MANUFACTURING TERMS & CONDITIONS OF SALE

WHEN ORDERING MATERIAL: Please use Merrill Manufacturing Company (herein after called "Merrill") order numbers, size and any other definite information necessary. Merrill reserves the right to correct clerical errors or omissions in quotations or other documents.

ACCEPTANCE OF ORDERS: All orders are subject to acceptance by Merrill's home office in Storm Lake, Iowa and to conditions stated herein. Merrill will not be bound by any terms or conditions on buyer's order which is different from or in addition to the terms and conditions of Merrill unless specifically accepted in writing by Merrill's home office. No changes or additions to current orders will be accepted if placed less than 48 hours prior to shipment. No additional items can be added to freight prepaid back orders.

PRICES AND QUOTATIONS: Orders will be invoiced at the price in effect at the time of shipment. Unless otherwise specified, prices are F.O.B. point of shipment. All prices and quotations are subject to change without notice. Items not listed in this catalog will be quoted on application.

CANCELLATION: Orders accepted by Merrill's home office in Storm Lake, Iowa are not subject to cancellation. But where cancellation is mutually agreed to, the purchaser will be billed for reasonable charges based on expenses incurred or will occur due to commitments made by Merrill for the cancelled order.

SPECIAL PRODUCTS: Products made or ordered to customer's specifications are not returnable or refundable. Requests for cancellation of such orders will not be granted if the manufacture of the product is in process, or if the material necessary to manufacture the product has been purchased when the request reaches Merrill's home office.

PRODUCT CHANGES: The right is reserved to make changes in pattern, design or materials when deemed necessary without prior notice. Products which have become obsolete by reason of design change or discontinued item for any reason, may not be returned for credit.

SHIPPING POLICY: Merrill may prepay and allow transportation charges to common carrier destinations within the continental United States or Canada, excluding Alaska and Hawaii, and pricing will be in accordance with the corresponding freight policy outlined in the Merrill discount schedule. We reserve the right to ship VIA most economical transportation means, routing of the shipment, and to select point of origin for the shipment. **Additional Freight Charges: Additional fees for residential, remote areas, or any special circumstance deliveries from the freight company will be the responsibility of the receiver of the shipment and a separate invoice will be issued upon receipt of notification of such charges. This applies to freight prepaid and allowed, and FOB pricing. The receiver of the shipment is to pay all additional fees.** If special routing or method is requested, resulting in a higher rate, the additional amount will be charged to the customer. Merrill will not be responsible for any extra charges, handling or otherwise, arising out of possible misdirected shipments to any location. If the specific error was Merrill's, only the additional freight charges involved in returning the shipment to Merrill, or the freight costs involved in forwarding the shipment to another location or company will be paid by Merrill. If the error in shipment was not specifically an error by Merrill, then no additional charges will be paid by Merrill.

- A. Merrill shall not be responsible for delays resulting from strikes, accidents, negligence of carriers, or any other causes beyond our control. Merrill may, during a period of shortage due to causes beyond its control prorate the supply of its products among all of its customers in such a manner as may be deemed equitable at the sole discretion of Merrill.

SAME DAY SHIPMENT POLICY: Any orders placed after 12:00 p.m. Central Time that must be shipped out the same day will incur an additional \$25.00 service charge and it must be shipped by next day air service (UPS, FedEx, etc.).

MINIMUM INVOICE: Merrill has no minimum invoice order amount. All accounts with restricted credit that order \$75.00 net or under must be shipped with credit card payment or C.O.D. unless otherwise approved by Merrill's credit department. Prompt paying accounts with open credit will have no minimum order or payment restrictions.

TAXES: Any taxes that may be imposed by law on the sale of articles made or sold by Merrill shall be added to the sale price of such articles.

TERMS OF PAYMENT: 2% 15 Days, Net 30 Days from date of invoice, and subject to approval of Merrill credit department.

TERMS & CONDITIONS OF SALE

INTEREST CHARGES: Merrill will add an 18% per annum handling charge, with a \$2.00 per month minimum, added to all invoices that are 15 days past due. All orders are held from shipment when any invoice on an account becomes 15 days past due.

At 60 days from the invoice date, or 30 days past due, an account is considered severely past due and in jeopardy of being placed for collection. If an account is placed for collection:

1. All future orders will be shipped on terms of prepay cash only. (CIA)
2. The dollar amount placed will include all collection agency fees and late charges.
3. An account will not be considered for open account status until the account is current and the account has submitted an audited current financial statement and credit application.

THE BUYER AGREES THAT PAYMENT OF COLLECTION AND LEGAL FEES IN ADDITION TO ANY UNPAID INVOICE AMOUNT IS REASONABLE IN LIGHT OF THE ANTICIPATED HARM THAT WOULD BE CAUSED BY THE BUYER'S BREACH.

RETURNED GOODS: All following policies must be met—

1. A detailed list of the material to be returned must be submitted, as well as supporting data as to when purchased, dates, and invoice numbers if available. Prior approval must be received in writing from Merrill's home office in Storm Lake, Iowa before any material is to be returned.
2. Credit will be allowed only on material of our manufacture or sold by us, and must be resalable, otherwise only scrap value will be issued.
3. Authorization and shipping instructions must be obtained from Merrill before returning any product. All product being returned must be shipped with transportation charges prepaid.
4. Any material returned to our company and not proven to be a manufacturing defect or not meeting all terms or policies for returned goods will carry a 25% restocking charge.
5. All returned material is subject to our plant count and inspection, and our inspection departments determination will be final.
6. ONLY OUR ISSUED CREDIT MEMOS WILL BE HONORED. THERE SHOULD NOT BE ANY DEDUCTION MADE BY ANYONE ON THEIR PAYMENTS AGAINST THEIR ACCOUNT WITHOUT OUR CREDIT MEMO NUMBER. ANY SUCH DEDUCTION BEING MADE WILL BE DISREGARDED AND WILL REMAIN OPEN ON THE ACCOUNT.
7. Merrill will not be responsible for any material returned without written authorization or total compliance with the above terms or policies.
8. All claims must be made within 30 days from the invoice date of the product.
9. Credit for product warranty on items sold by Merrill, but not manufactured by Merrill, will be issued ONLY after Merrill has been allowed credit by the manufacturer of the product in question. In most cases this may cause some delay in credit being issued. Warranty determination is at the discretion of the original manufacturer and not Merrill. Merrill can not issue credit on products that are old, abused, or where credit is otherwise not allowed by the original manufacturer.

COMPLAINTS: Complaints, controversy, or claims arising out of or related to Merrill products should be made at once to the Merrill's home office in Storm Lake, Iowa. All reasonable efforts (as determined by Merrill) will be made by Merrill management to correct or settle the complaints, controversy, or claims between directly involved parties without third party, or legal involvement. Any complaint, controversy, or claim arising out of or related to Merrill product, this contract, or the breach thereof, not settled between Merrill and claimant, shall be settled by arbitration, administered by the American Arbitration Association in accordance with its credit account arbitration rules. The judgement on the award rendered by the arbitrator may be entered in the Iowa court having jurisdiction in the Merrill home office area thereof.

ERRORS, SHORTAGES, AND CLAIMS FOR DAMAGED OR LOST GOODS: All claims for shortages or errors must be made within 30 days from the date of invoice and **claims must be placed with the carrier or transportation company within 15 days for damaged or lost goods.** Merrill is not responsible for goods after they have been delivered in good condition to the carrier or transportation company. Merrill does not, unless under previous written agreement, insure shipments beyond the point of delivery to such carrier.

**IT IS THE CUSTOMER'S RESPONSIBILITY FOR ORDERING PROPER PRODUCT
TO MEET LOCAL, STATE AND FEDERAL CODE REGULATIONS.**

2/22/2006

HIDE-DRANT®

The Removable and Sanitary Hydrant

Features/Benefits

- 1) **Sanitary Yard Hydrant**
Approved in Illinois, Indiana, Michigan, Ohio, and Wisconsin - the toughest/ most restrictive states in the U.S.
Benefit – Only reasonably priced sanitary hydrant. Also the most trouble free, no flow time required.
- 2) **Frost Proof**
When used correctly, simply turn counter-clockwise three turns to disconnect and remove stand pipe, then drain stand pipe for freezing temperatures.
Benefit – Very simple, no tools required to remove and reinstall stand pipe.
- 3) **Stop Valve At Bottom Of Hide-Drant®**
Is automatically opened when stand pipe is reinstalled. Seals between stop valve and stand pipe holds water before valve is reopened. Stop valve available in PVC or stainless steel.
Benefit – Very simple, reliable stop valve. One moving part, stainless steel spring, also designed so field repairable.
- 4) **Outlet Can Be In Any Direction**
By simply pivoting outlet counter-clockwise to direction desired, approximately three revolutions needed to remove stand pipe. Do **NOT** over tighten stand pipe by forcing clockwise revolution of outlet.
Benefit – Only hydrant that allows outlet to be in any direction, no tools required – pivots by hand.
- 5) **Non-Corrosive Construction**
To insure a long operating life, stop valve available in PVC or stainless steel and other components are made of non-corrosive materials.
Benefit – Quality, non-corrosive construction for years of service.
- 6) **Bottom Case**
Has one way flapper drain to remove any spilled water in case, plus cover over drain on outside of case protects drain from backfill.
Benefit – Helps bottom case and stop valve to stay sanitary.
- 7) **No Tools Required** (After initial installation)
Hydrant riser pipe can be removed and reinstalled in seconds with only a few turns. Do not use tools.
- 8) **Removable Riser Pipe**
So you can mow right over the bottom case and improves appearance of landscape for additional applications.
- 9) **No Lead Compliance**
Models available in both yard hydrant and straight models, that are No-Lead.
- 10) **Available In All Bury Depths From 1 Foot to 8 Foot**

Optional Hide-Drant® Locking Cap Available
(Part No. on Parts List)

U.S. Patent # 6,116,265

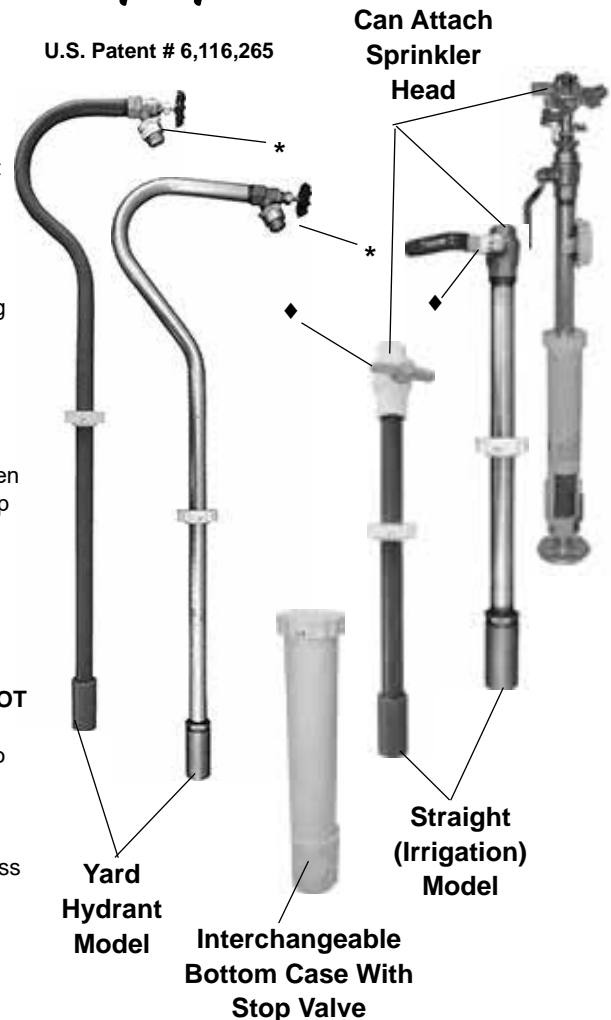

* ASSE Approved Vacuum Breaker and Outlet Valve Included

♦ Ball Valve Included

Approved by states that require the approval for sanitary hydrants Illinois, Indiana, Michigan, Ohio, and Wisconsin



Call Merrill for applications you may need.
Custom models available.



HIDE-DRANT®

The Removable and Sanitary Hydrant With Stainless Steel Stop Valve and Galvanized Pipe

Specifications For Stainless Steel Standard 3/4"

Inlet-3/4" Female NPT Into Stainless Steel
Outlet-3/4" No Lead Brass Vacuum Breaker
Stand Pipe 3/4" Galvanized Pipe
Bottom Case 1-1/2" Sch. 40 PVC-Includes:
Repairable Stainless Steel Stop Valve

Flow Rate: Standard 3/4" Hide-Drant® With Vacuum Breaker

Flow Rate: Standard 3/4" Hide-Drant® Without Vacuum Breaker

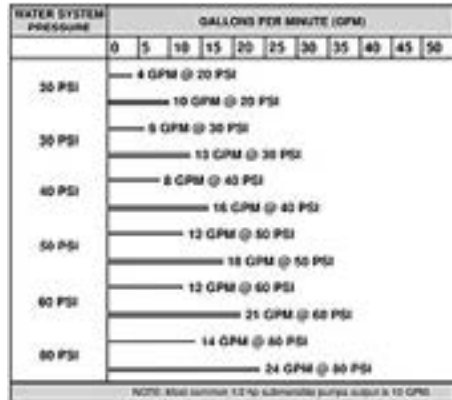

Specifications For Interchangeable 3/4" Bottom Case Stainless Steel Stop Valve

Inlet-3/4" Female NPT Into Stainless Steel
Outlet-Repairable Stainless Steel Stop Valve
Bottom Case 1-1/2" Sch. 40 PVC-Includes:
Repairable Stainless Steel Stop Valve
Ground Level Cap Attaches To 1-1/2" PVC

Specifications For Stainless Steel Straight 3/4"

Inlet-3/4" Female NPT Into Stainless Steel
Outlet-3/4" No Lead Brass Ball Valve
Stand Pipe 3/4" Galvanized Pipe
Bottom Case 1-1/2" Sch. 40 PVC-Includes:
Repairable Stainless Steel Stop Valve

Flow Rate: Straight 3/4" Hide-Drant® With Ball Valve

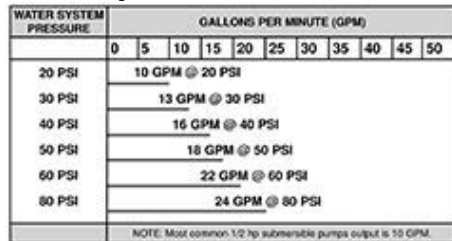

WARNING: This hydrant must have the stand pipe removed and water drained out of pipe when freezing temperatures may be present. Warranty does not cover damage due to freezing temperatures or water frozen within the product.



Standard Stainless Steel/ Galv. 3/4" Hide-Drant® Complete:

Order No.	UPC Bar Code (Qty.1)	Inlet Size x Depth	Bury Depth	Approx. Wt./Lbs.	Overall Length
★HIDESS27501	6 42367 10585 3	3/4" x 1'		6.3	40.0"
★HIDESS27502	6 42367 10586 0	3/4" x 2'		7.9	52.0"
★HIDESS27503	6 42367 10587 7	3/4" x 3'		9.5	64.0"
★HIDESS27504	6 42367 10588 4	3/4" x 4'		11.1	76.0"
★HIDESS27505	6 42367 10589 1	3/4" x 5'		12.7	88.0"
★HIDESS27506	6 42367 10590 7	3/4" x 6'		14.3	100.0"
★HIDESS27507	6 42367 10591 4	3/4" x 7'		15.9	112.0"
★HIDESS27508	6 42367 10592 1	3/4" x 8'		17.5	124.0"

Interchangeable 3/4" Bottom Case w/Stainless Steel Stop Valve:

Order No.	UPC Bar Code (Qty.1)	Inlet Size x Depth	Bury Depth	Approx. Wt./Lbs.	Overall Length
★HIDBCS27501	6 42367 10593 8	3/4" x 1'		1.4	12.0"
★HIDBCS27502	6 42367 10594 5	3/4" x 2'		1.9	24.0"
★HIDBCS27503	6 42367 10595 2	3/4" x 3'		2.4	36.0"
★HIDBCS27504	6 42367 10596 9	3/4" x 4'		2.9	48.0"
★HIDBCS27505	6 42367 10597 6	3/4" x 5'		3.4	60.0"
★HIDBCS27506	6 42367 10598 3	3/4" x 6'		3.9	72.0"
★HIDBCS27507	6 42367 10599 0	3/4" x 7'		4.4	84.0"
★HIDBCS27508	6 42367 10600 3	3/4" x 8'		4.9	96.0"

Straight Stainless Steel/Galv. 3/4" Inlet Hide-Drant® Complete:

Order No.	UPC Bar Code (Qty.1)	Inlet Size x Depth	Bury Depth	Approx. Wt./Lbs.	Overall Length
★HIDETSS27501	6 42367 10601 0	3/4" x 1'		4.3	22.0"
★HIDETSS27502	6 42367 10602 7	3/4" x 2'		5.9	34.0"
★HIDETSS27503	6 42367 10603 4	3/4" x 3'		7.5	46.0"
★HIDETSS27504	6 42367 10604 1	3/4" x 4'		9.1	58.0"
★HIDETSS27505	6 42367 10605 8	3/4" x 5'		10.7	70.0"
★HIDETSS27506	6 42367 10606 5	3/4" x 6'		12.3	82.0"
★HIDETSS27507	6 42367 10607 2	3/4" x 7'		13.9	94.0"
★HIDETSS27508	6 42367 10608 9	3/4" x 8'		15.5	106.0"

Standard 3/4" Hide-Drant® Galvanized Stand Pipe Only:

Order No.	UPC Bar Code (Qty.1)	Inlet Size x Depth	Bury Depth	Approx. Wt./Lbs.	Overall Length
★HIDESPG201	6 42367 10609 6	3/4" x 1'		4.9	38.0"
★HIDESPG202	6 42367 10610 2	3/4" x 2'		6.0	50.0"
★HIDESPG203	6 42367 10611 9	3/4" x 3'		7.1	62.0"
★HIDESPG204	6 42367 10612 6	3/4" x 4'		8.2	74.0"
★HIDESPG205	6 42367 10613 3	3/4" x 5'		9.3	86.0"
★HIDESPG206	6 42367 10614 0	3/4" x 6'		10.4	98.0"
★HIDESPG207	6 42367 10615 7	3/4" x 7'		11.5	110.0"
★HIDESPG208	6 42367 10616 4	3/4" x 8'		12.6	122.0"

Straight 3/4" Hide-Drant® Galvanized Stand Pipe Only:

Order No.	UPC Bar Code (Qty.1)	Inlet Size x Depth	Bury Depth	Approx. Wt./Lbs.	Overall Length
★HIDESPSG201	6 42367 10649 2	3/4" x 1'		2.9	21.0"
★HIDESPSG202	6 42367 10650 8	3/4" x 2'		4.0	33.0"
★HIDESPSG203	6 42367 10651 5	3/4" x 3'		5.1	45.0"
★HIDESPSG204	6 42367 10652 2	3/4" x 4'		6.2	57.0"
★HIDESPSG205	6 42367 10653 9	3/4" x 5'		7.3	69.0"
★HIDESPSG206	6 42367 10654 6	3/4" x 6'		8.4	81.0"
★HIDESPSG207	6 42367 10655 3	3/4" x 7'		9.5	93.0"
★HIDESPSG208	6 42367 10656 0	3/4" x 8'		10.6	105.0"

☆ No Lead

HIDE-DRANT®

The Removable and Sanitary Hydrant - All PVC

Specifications For Standard 3/4"

Inlet-3/4" Female NPT Into Extra Heavy Wall PVC
Outlet-3/4" No Lead Brass Vacuum Breaker
Stand Pipe 3/4" Sch. 80 PVC
Bottom Case 1-1/2" Sch. 40 PVC-Includes:
Repairable Stop Valve w/Stainless Steel Spring

Flow Rate: Standard 3/4" Hide-Drant® With Vacuum Breaker _____

Flow Rate: Standard 3/4" Hide-Drant® Without Vacuum Breaker _____



Specifications For Interchangeable All PVC 3/4" Bottom Case Only

Inlet-3/4" Female NPT Into Extra Heavy Wall PVC
Outlet-Repairable Stop Valve w/Stainless Steel Spring
Bottom Case 1-1/2" Sch. 40 PVC-Includes:
Repairable Stop Valve w/Stainless Steel Spring
Ground Level Cap Attaches To 1-1/2" PVC

Specifications For Straight 3/4"

Inlet-3/4" Female NPT Into Extra Heavy Wall PVC
Outlet-3/4" PVC Ball Valve
Stand Pipe 3/4" Sch. 80 PVC
Bottom Case 1-1/2" Sch. 40 PVC-Includes:
Repairable Stop Valve w/Stainless Steel Spring

Flow Rate: Straight 3/4" Hide-Drant® With Ball Valve _____

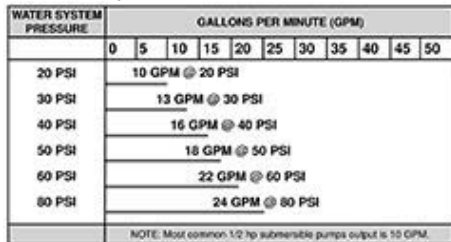

WARNING: This hydrant must have the stand pipe removed and water drained out of pipe when freezing temperatures may be present. Warranty does not cover damage due to freezing temperatures or water frozen within the product.



Standard All PVC 3/4" Hide-Drant® Complete:

Order No.	UPC Bar Code (Qty.1)	Inlet Size x Depth	Bury	Approx. Wt./Lbs.	Overall Length
☆ HIDE27501	6 42367 10617 1	3/4" x 1'		2.8	40.0"
☆ HIDE27502	6 42367 10618 8	3/4" x 2'		3.5	52.0"
☆ HIDE27503	6 42367 10619 5	3/4" x 3'		4.3	64.0"
☆ HIDE27504	6 42367 10620 1	3/4" x 4'		5.0	76.0"
☆ HIDE27505	6 42367 10621 8	3/4" x 5'		5.8	88.0"
☆ HIDE27506	6 42367 10622 5	3/4" x 6'		6.5	100.0"
☆ HIDE27507	6 42367 10623 2	3/4" x 7'		7.3	112.0"
☆ HIDE27508	6 42367 10624 9	3/4" x 8'		8.0	124.0"

Interchangeable All PVC 3/4" Bottom Case w/Stop Valve:

Order No.	UPC Bar Code (Qty.1)	Inlet Size x Depth	Bury	Approx. Wt./Lbs.	Overall Length
☆ HIDEBC27501	6 42367 10625 6	3/4" x 1'		0.9	12.0"
☆ HIDEBC27502	6 42367 10626 3	3/4" x 2'		1.4	24.0"
☆ HIDEBC27503	6 42367 10627 0	3/4" x 3'		1.9	36.0"
☆ HIDEBC27504	6 42367 10628 7	3/4" x 4'		2.4	48.0"
☆ HIDEBC27505	6 42367 10629 4	3/4" x 5'		2.9	60.0"
☆ HIDEBC27506	6 42367 10630 0	3/4" x 6'		3.4	72.0"
☆ HIDEBC27507	6 42367 10631 7	3/4" x 7'		3.9	84.0"
☆ HIDEBC27508	6 42367 10632 4	3/4" x 8'		4.4	96.0"

Straight All PVC 3/4" Inlet Hide-Drant® Complete:

Order No.	UPC Bar Code (Qty.1)	Inlet Size x Depth	Bury	Approx. Wt./Lbs.	Overall Length
☆ HIDE27501	6 42367 10633 1	3/4" x 1'		1.8	22.0"
☆ HIDE27502	6 42367 10634 8	3/4" x 2'		2.5	34.0"
☆ HIDE27503	6 42367 10635 5	3/4" x 3'		3.3	46.0"
☆ HIDE27504	6 42367 10636 2	3/4" x 4'		4.0	58.0"
☆ HIDE27505	6 42367 10637 9	3/4" x 5'		4.8	70.0"
☆ HIDE27506	6 42367 10638 6	3/4" x 6'		5.5	82.0"
☆ HIDE27507	6 42367 10639 3	3/4" x 7'		6.3	94.0"
☆ HIDE27508	6 42367 10640 9	3/4" x 8'		7.0	106.0"

Standard All PVC 3/4" Hide-Drant® Stand Pipe Only:

Order No.	UPC Bar Code (Qty.1)	Inlet Size x Depth	Bury	Approx. Wt./Lbs.	Overall Length
☆ HIDE27501	6 42367 10641 6	3/4" x 1'		1.9	38.0"
☆ HIDE27502	6 42367 10642 3	3/4" x 2'		2.2	50.0"
☆ HIDE27503	6 42367 10643 0	3/4" x 3'		2.4	62.0"
☆ HIDE27504	6 42367 10644 7	3/4" x 4'		2.7	74.0"
☆ HIDE27505	6 42367 10645 4	3/4" x 5'		2.9	86.0"
☆ HIDE27506	6 42367 10646 1	3/4" x 6'		3.2	98.0"
☆ HIDE27507	6 42367 10647 8	3/4" x 7'		3.4	110.0"
☆ HIDE27508	6 42367 10648 5	3/4" x 8'		3.7	122.0"

Straight All PVC 3/4" Hide-Drant® Stand Pipe Only:

Order No.	UPC Bar Code (Qty.1)	Inlet Size x Depth	Bury	Approx. Wt./Lbs.	Overall Length
☆ HIDE27501	6 42367 10657 7	3/4" x 1'		0.9	21.0"
☆ HIDE27502	6 42367 10658 4	3/4" x 2'		1.2	33.0"
☆ HIDE27503	6 42367 10659 1	3/4" x 3'		1.4	45.0"
☆ HIDE27504	6 42367 10660 7	3/4" x 4'		1.7	57.0"
☆ HIDE27505	6 42367 10661 4	3/4" x 5'		1.9	69.0"
☆ HIDE27506	6 42367 10662 1	3/4" x 6'		2.2	81.0"
☆ HIDE27507	6 42367 10663 8	3/4" x 7'		2.4	93.0"
☆ HIDE27508	6 42367 10664 5	3/4" x 8'		2.7	108.0"

HIDE-DRANT® PARTS LIST

The expanded line of Hide-Drant® has several improvements, and has changed to 1-1/2" PVC bottom case, plus all PVC or stainless steel valve. Galvanized pipe models are now available.

Item No.	Part No.	Part Description
2	☆ HIDE202	Centering Collar For Pipe
3	☆ BBDNL75FA	3/4" No Lead Brass Outlet Valve
4	☆ BVBNL75M	3/4" No Lead Vacuum Breaker
5	☆ HIDE205	Top Cap For 1-1/2" PVC
6	☆ HIDE203	3/4" PVC Ball Valve
7	☆ BBVNL75	3/4" No Lead Brass Ball Valve
8		Call For Application—Several Lengths
9		Call For Application—Several Lengths
10		Call For Application—Several Lengths
11		Call For Application—Several Lengths
12		Call For Application—Several Lengths
13		Call For Application—Several Lengths
14	☆ CBD75FA	3/4" Celcon Boiler Drain (Optional) (No Lead Compliance)
	☆ HIDE202	Optional Locking Cap

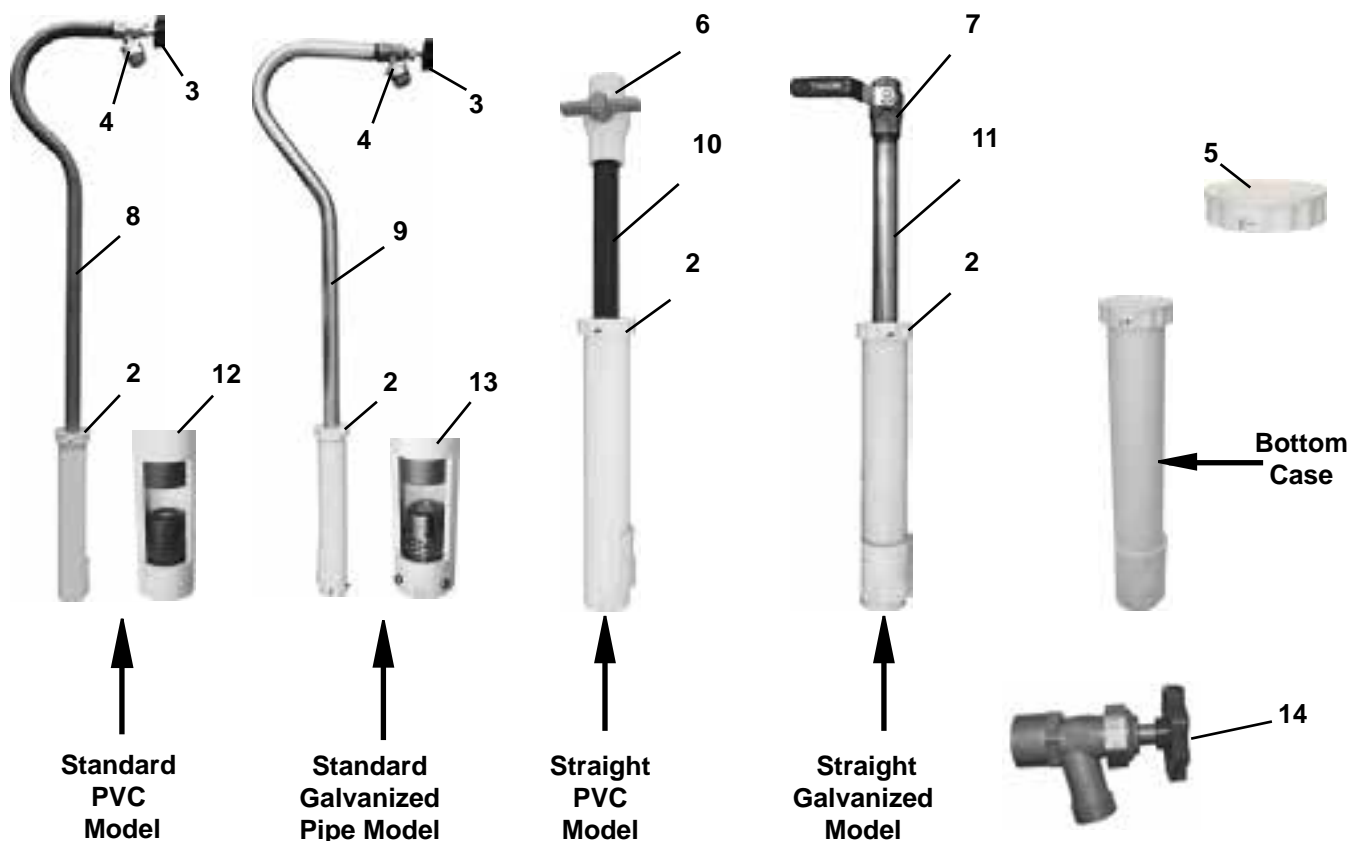

ANY FLOW

FROST PROOF YARD HYDRANT FEATURES/BENEFITS

The Merrill *Any Flow* Yard Hydrant gives year 'round water service; it drains below the frostline when shut off. The *Any Flow* Hydrant has had only a few improvements since 1949. These improvements, the exclusive features and benefits, and the time-proven basic design, is why we believe the *Any Flow* is the best yard hydrant manufactured by anyone.

- * (1) **LEVER CONTROL** operates by cam principle and provides variable flow from trickle to full force.
BENEFIT: Variable flow with no lock that rusts in place.
- (2) **DRAW STRAPS** are made of 1040 hot rolled steel which is much harder (Brinell 175/200) and stronger. Greatly reduces wear of straps and eliminates side pull on operating rod.
BENEFIT: Longest operating life.
- * (3) **STAINLESS STEEL OPERATING ROD** is ground and polished and will not cut out packing and packing nut, like brass rod used by other companies.
BENEFIT: Best material for longest operating life.
- (4) **HEAVY-DUTY HOSE ADAPTER** threaded for standard 3/4" hose coupling.
BENEFIT: Standard hose fitting readily available.
- (5) **EXTRA THICK WALLED HEAD CASTING** greatly reduces breakage and insures longer life.
BENEFIT: Time-proven heavy-duty design takes years of abuse.
- * (6) **PIVOT CONNECTOR WITH TWO NUTS** provides simple positive adjustment and eliminates unreliable set screws.
BENEFIT: Adjustable for years, not like rusted in set screws.
- (7) **NO EXPOSED THREADS** on galvanized rod and threads on galvanized pipe are coated with bitumastic to prevent rusting and prolong life of hydrant.
BENEFIT: No exposed steel to rust.
- (8) **EXTRA THICK WALLED VALVE BODY** to insure longer life and trouble free service.
BENEFIT: Time-proven heavy-duty design.
- * (9) **PATENTED PLUNGER ARRANGEMENT** ensures even flow from trickle to full force. Closes drain at any flow rate and opens drain in off position to prevent freezing.
BENEFIT: Longest operating life available in the industry by over 200%.
- * (10) **KRAYTON G CUP SEALS** provides a much longer life than leather, close tolerance uniformity, unaffected by chemicals and passed a 1 million cycle test.
BENEFIT: Longest operating seals in the industry.
- (11) **3/8L BEVELED BIBB WASHER** made of SBR compound with 90 Durometer hardness, assures positive shut-off and longer life than soft one piece plunger.
BENEFIT: Longer operating life than all competitors.
- * (12) **STAINLESS STEEL SPRING** takes up slack of normal wear and eliminates numerous adjustments of hydrant head linkage.
BENEFIT: Automatically adjusts for years of service.
- * (13) **SWIVEL PARTS** permit withdrawal of moving parts without digging up hydrant. Nothing in head assembly to disconnect or adjust when removing. Simply unscrew entire head assembly from galvanized pipe and pull up valve stem with plunger for inspection.
BENEFIT: If parts don't swivel, they could be unscrewed from rod when taking off head above ground.

*EXCLUSIVE MERRILL QUALITY FEATURES

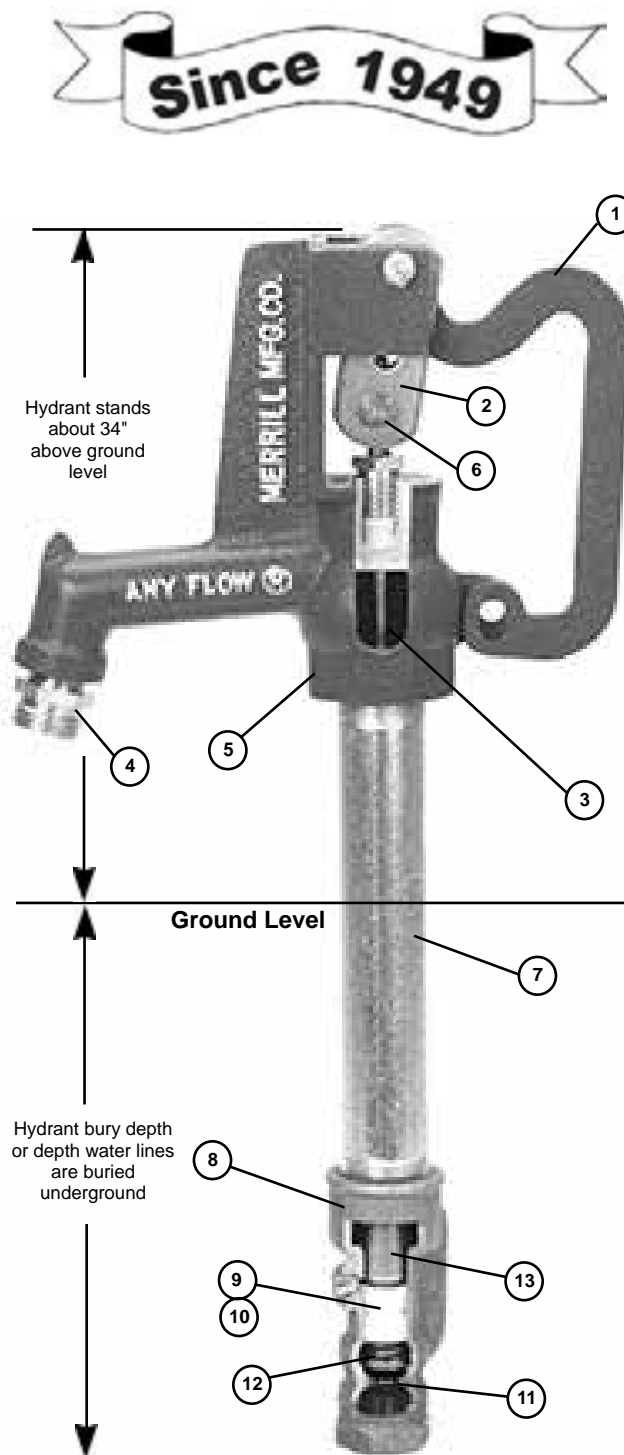

Merrill's AF7504 or 4' Bury Hydrant is about 6' - 9-1/2" long.
4' is buried and 34" is above ground.

☆ No Lead

ANY FLOW



Any Flow
Hydrant



Stainless Steel
Any Flow
Hydrant



Hi-Capacity
Any Flow
Hydrant

SPECIFICATIONS Standard 3/4" ANY FLOW

Inlet - 3/4" NPT in Heavy Casting
Outlet - 3/4" Hose Thread Adapter
Stainless Steel Operating Rod Thru Teflon Packing
Automatic Self-Adjusting Plunger
1" Galvanized Stand Pipe and 7/16"
Galvanized Operating Rod

STANDARD 3/4" ANY FLOW FROST PROOF YARD HYDRANTS

Order No.	UPC Bar Code (Qty. 1)	Pipe Connection x Pipe Depth	Stand Pipe	Overall Length	Approx. Wt./Lbs.
AF7501	6 42367 00738 6	3/4" x 1' Bury	1" Galv.	45.5"	13.5
AF7502	6 42367 00739 3	3/4" x 2' Bury	1" Galv.	57.5"	15.5
AF7503	6 42367 00740 9	3/4" x 3' Bury	1" Galv.	69.5"	17.5
AF7504	6 42367 00741 6	3/4" x 4' Bury	1" Galv.	81.5"	19.5
AF7505	6 42367 00742 3	3/4" x 5' Bury	1" Galv.	93.5"	21.5
AF7506	6 42367 00743 0	3/4" x 6' Bury	1" Galv.	105.5"	23.5
AF7507	6 42367 00744 7	3/4" x 7' Bury	1" Galv.	117.5"	25.5
AF7508	6 42367 00745 4	3/4" x 8' Bury	1" Galv.	129.5"	27.5
AF7510	6 42367 00746 1	3/4" x 10' Bury	1" Galv.	153.5"	31.5

STAINLESS STEEL 3/4" ANY FLOW FROST PROOF YARD HYDRANTS

Order No.	UPC Bar Code (Qty. 1)	Pipe Connection x Pipe Depth	Stand Pipe	Overall Length	Approx. Wt./Lbs.
AFB7501	6 42367 00747 8	3/4" x 1' Bury	1" Stainless Steel	45.5"	14.0
AFB7502	6 42367 00748 5	3/4" x 2' Bury	1" Stainless Steel	57.5"	16.0
AFB7503	6 42367 00749 2	3/4" x 3' Bury	1" Stainless Steel	69.5"	18.0
AFB7504	6 42367 00750 8	3/4" x 4' Bury	1" Stainless Steel	81.5"	20.5
AFB7505	6 42367 00751 5	3/4" x 5' Bury	1" Stainless Steel	93.5"	22.5
AFB7506	6 42367 00752 2	3/4" x 6' Bury	1" Stainless Steel	105.5"	24.5
AFB7507	6 42367 00753 9	3/4" x 7' Bury	1" Stainless Steel	117.5"	27.0
AFB7508	6 42367 00754 6	3/4" x 8' Bury	1" Stainless Steel	129.5"	29.0
AFB7510	6 42367 00755 3	3/4" x 10' Bury	1" Stainless Steel	153.5"	33.0

SPECIFICATIONS NO LEAD 3/4" ANY FLOW

Inlet - 3/4" NPT in Heavy No Lead Casting
Outlet - 3/4" No Lead Hose Thread Adapter
Stainless Steel Operating Rod Thru Teflon Packing
Automatic Self-Adjusting Plunger
No Lead Brass Valve Body
1" Galvanized Stand Pipe and 7/16"
Galvanized Operating Rod

NO LEAD 3/4" ANY FLOW FROST PROOF YARD HYDRANTS

Order No.	UPC Bar Code (Qty. 1)	Pipe Connection x Pipe Depth	Stand Pipe	Overall Length	Approx. Wt./Lbs.
☆ AFNL7501	6 42367 41806 9	3/4" x 1' Bury	1" Galv.	45.5"	13.5
☆ AFNL75015	6 42367 42428 2	3/4" x 1-1/2' Bury	1" Galv.	51.5"	14.7
☆ AFNL7502	6 42367 41807 6	3/4" x 2' Bury	1" Galv.	57.5"	15.5
☆ AFNL7503	6 42367 41808 3	3/4" x 3' Bury	1" Galv.	69.5"	17.5
☆ AFNL7504	6 42367 41809 0	3/4" x 4' Bury	1" Galv.	81.5"	19.5
☆ AFNL7505	6 42367 41810 6	3/4" x 5' Bury	1" Galv.	93.5"	21.5
☆ AFNL7506	6 42367 41811 3	3/4" x 6' Bury	1" Galv.	105.5"	23.5
☆ AFNL7507	6 42367 41812 0	3/4" x 7' Bury	1" Galv.	117.5"	25.5
☆ AFNL7508	6 42367 41813 7	3/4" x 8' Bury	1" Galv.	129.5"	27.5
☆ AFNL7510	6 42367 41814 4	3/4" x 10' Bury	1" Galv.	153.5"	31.5

NO LEAD STAINLESS STEEL 3/4" ANY FLOW FROST PROOF YARD HYDRANTS

SPECIFICATIONS - NO LEAD Stainless Steel 3/4" ANY FLOW

Inlet - 3/4" NPT in Heavy No Lead Casting
Outlet - 3/4" No Lead Hose Thread Adapter
Stainless Steel Operating Rod Thru Teflon Packing
Automatic Self-Adjusting Plunger
No Lead Brass Valve Body
1" Stainless Steel Pipe and 7/16" Stainless Steel
Rod

Order No.	UPC Bar Code (Qty. 1)	Pipe Connection x Pipe Depth	Stand Pipe	Overall Length	Approx. Wt./Lbs.
☆ AFBNL7501	6 42367 41815 1	3/4" x 1' Bury	1" Stainless Steel	45.5"	14.0
☆ AFBNL7502	6 42367 41816 8	3/4" x 2' Bury	1" Stainless Steel	57.5"	16.0
☆ AFBNL7503	6 42367 41817 5	3/4" x 3' Bury	1" Stainless Steel	69.5"	18.0
☆ AFBNL7504	6 42367 41818 2	3/4" x 4' Bury	1" Stainless Steel	81.5"	20.5
☆ AFBNL7505	6 42367 41819 9	3/4" x 5' Bury	1" Stainless Steel	93.5"	22.5
☆ AFBNL7506	6 42367 41820 5	3/4" x 6' Bury	1" Stainless Steel	105.5"	24.5
☆ AFBNL7507	6 42367 41821 2	3/4" x 7' Bury	1" Stainless Steel	117.5"	27.0
☆ AFBNL7508	6 42367 41822 9	3/4" x 8' Bury	1" Stainless Steel	129.5"	29.0
☆ AFBNL7510	6 42367 41823 6	3/4" x 10' Bury	1" Stainless Steel	153.5"	33.0

ANY FLOW HI-CAPACITY

SPECIFICATIONS

Hi-Capacity 1" ANY FLOW

Inlet - 1" NPT in Heavy Casting
 Outlet - 3/4" Hose Thread Adapter
 and Outside of Nozzle has 1" Pipe Thread
 Stainless Steel Operating Rod Thru Teflon Packing
 Automatic Self-Adjusting Plunger
 1-1/4" Galvanized Stand Pipe and 7/16"
 Galvanized Operating Rod

HI-CAPACITY 1" ANY FLOW FROST PROOF YARD HYDRANTS

Order No.	UPC Bar Code (Qty. 1)	Pipe Connection x Pipe Depth	Stand Pipe	Overall Length	Approx. Wt./Lbs.
AF101	6 42367 00729 4	1" x 1' Bury	1-1/4" Galv.	45.5"	16.0
AF102	6 42367 00730 0	1" x 2' Bury	1-1/4" Galv.	57.5"	18.5
AF103	6 42367 00731 7	1" x 3' Bury	1-1/4" Galv.	69.5"	21.0
AF104	6 42367 00732 4	1" x 4' Bury	1-1/4" Galv.	81.5"	23.5
AF105	6 42367 00733 1	1" x 5' Bury	1-1/4" Galv.	93.5"	26.0
AF106	6 42367 00734 8	1" x 6' Bury	1-1/4" Galv.	105.5"	28.5
AF107	6 42367 00735 5	1" x 7' Bury	1-1/4" Galv.	117.5"	31.0
AF108	6 42367 00736 2	1" x 8' Bury	1-1/4" Galv.	129.5"	33.5
AF110	6 42367 00737 9	1" x 10' Bury	1-1/4" Galv.	153.5"	38.5

SPECIFICATIONS

No Lead Hi-Capacity 1" ANY FLOW

Inlet - 1" NPT in Heavy Casting
 Outlet - 3/4" No Lead Hose Thread Adapter
 and Outside of Nozzle has 1" Pipe Thread
 Stainless Steel Operating Rod Thru Teflon Packing
 Automatic Self-Adjusting Plunger
 No Lead Brass Valve Body
 1-1/4" Galvanized Stand Pipe and 7/16"
 Galvanized Operating Rod

NO LEAD HI-CAP 1" ANY FLOW FROST PROOF YARD HYDRANTS

Order No.	UPC Bar Code (Qty. 1)	Pipe Connection x Pipe Depth	Stand Pipe	Overall Length	Approx. Wt./Lbs.
☆ AFNL101	6 42367 42071 0	1" x 1' Bury	1-1/4" Galv.	45.5"	16.0
☆ AFNL102	6 42367 42072 7	1" x 2' Bury	1-1/4" Galv.	57.5"	18.5
☆ AFNL103	6 42367 42073 4	1" x 3' Bury	1-1/4" Galv.	69.5"	21.0
☆ AFNL104	6 42367 42074 1	1" x 4' Bury	1-1/4" Galv.	81.5"	23.5
☆ AFNL105	6 42367 42070 3	1" x 5' Bury	1-1/4" Galv.	93.5"	26.0
☆ AFNL106	6 42367 42075 8	1" x 6' Bury	1-1/4" Galv.	105.5"	28.5
☆ AFNL107	6 42367 42076 5	1" x 7' Bury	1-1/4" Galv.	117.5"	31.0
☆ AFNL108	6 42367 42077 2	1" x 8' Bury	1-1/4" Galv.	129.5"	33.5
☆ AFNL110	6 42367 42078 9	1" x 10' Bury	1-1/4" Galv.	153.5"	38.5

SPECIFICATIONS

Hi-Capacity Stainless Steel 1" ANY FLOW

Inlet - 1" NPT in Heavy Casting
 Outlet - 3/4" Hose Thread Adapter and Outside of
 Nozzle has 1" Pipe Thread
 Stainless Steel Operating Rod Thru Teflon Packing
 Automatic Self-Adjusting Plunger
 1-1/4" Stainless Steel Pipe and 7/16" Stainless
 Steel Operating Rod

HI-CAPACITY STAINLESS STEEL 1" ANY FLOW FROST PROOF YARD HYDRANTS

Order No.	UPC Bar Code (Qty. 1)	Pipe Connection x Pipe Depth	Stand Pipe	Overall Length	Approx. Wt./Lbs.
AFB101	6 42367 43486 1	1" x 1' Bury	1-1/4" Stainless Steel	45.5"	16.0
AFB102	6 42367 43487 8	1" x 2' Bury	1-1/4" Stainless Steel	57.5"	18.5
AFB103	6 42367 43488 5	1" x 3' Bury	1-1/4" Stainless Steel	69.5"	21.0
AFB104	6 42367 43489 2	1" x 4' Bury	1-1/4" Stainless Steel	81.5"	23.5
AFB105	6 42367 43490 8	1" x 5' Bury	1-1/4" Stainless Steel	93.5"	26.0
AFB106	6 42367 43491 5	1" x 6' Bury	1-1/4" Stainless Steel	105.5"	28.5
AFB107	6 42367 43492 2	1" x 7' Bury	1-1/4" Stainless Steel	117.5"	31.0
AFB108	6 42367 43493 9	1" x 8' Bury	1-1/4" Stainless Steel	129.5"	33.5
AFB110	6 42367 43494 6	1" x 10' Bury	1-1/4" Stainless Steel	153.5"	38.5

SPECIFICATIONS - NO LEAD

Hi-Capacity Stainless Steel 1" ANY FLOW

Inlet - 1" NPT in Heavy No Lead Casting
 Outlet - 3/4" No Lead Hose Thread Adapter and
 Outside of Nozzle has 1" Pipe Thread
 Stainless Steel Operating Rod Thru Teflon Packing
 Automatic Self-Adjusting Plunger
 No Lead Brass Valve Body
 1-1/4" Stainless Steel Pipe and 7/16" Stainless
 Steel Operating Rod

NO LEAD HI-CAPACITY STAINLESS STEEL 1" ANY FLOW FROST PROOF YARD HYDRANTS

Order No.	UPC Bar Code (Qty. 1)	Pipe Connection x Pipe Depth	Stand Pipe	Overall Length	Approx. Wt./Lbs.
☆ AFBNL101	6 42367 43495 3	1" x 1' Bury	1-1/4" Stainless Steel	45.5"	16.0
☆ AFBNL102	6 42367 43496 0	1" x 2' Bury	1-1/4" Stainless Steel	57.5"	18.5
☆ AFBNL103	6 42367 43497 7	1" x 3' Bury	1-1/4" Stainless Steel	69.5"	21.0
☆ AFBNL104	6 42367 43498 4	1" x 4' Bury	1-1/4" Stainless Steel	81.5"	23.5
☆ AFBNL105	6 42367 43499 1	1" x 5' Bury	1-1/4" Stainless Steel	93.5"	26.0
☆ AFBNL106	6 42367 43500 4	1" x 6' Bury	1-1/4" Stainless Steel	105.5"	28.5
☆ AFBNL107	6 42367 43501 1	1" x 7' Bury	1-1/4" Stainless Steel	117.5"	31.0
☆ AFBNL108	6 42367 43502 8	1" x 8' Bury	1-1/4" Stainless Steel	129.5"	33.5
☆ AFBNL110	6 42367 43503 5	1" x 10' Bury	1-1/4" Stainless Steel	153.5"	38.5

ANY FLOW

☆ No Lead

❖ CA. Certified

PARTS KIT "AF"

Qty.	Part No.
1 Pr.	G-20
1	G-25
1	G-30
1	G-35
1	G-115
1	OR110

ORDER NO. PKAF
UPC Bar Code (Qty. 1)
6 42367 02213 6



PARTS KIT HI-CAPACITY MODEL

Qty.	Part No.
1 Pr.	G-20
1	G-25
1	G-30
1	G-35
1	G-116
1	OR110

ORDER NO. PKA1F
UPC Bar Code (Qty. 1)
6 42367 41865 6



PARTS KIT "A"

Qty.	Part No.
2	G-6
4 Pr.	G-20
1	G-25
3	G-30
4	G-35
4	G-45
3	G-50
8	G-85
6 Pr.	G-105
2	G-115
4	OR110

ORDER NO. PKA
UPC Bar Code (Qty. 1)
6 42367 02212 9

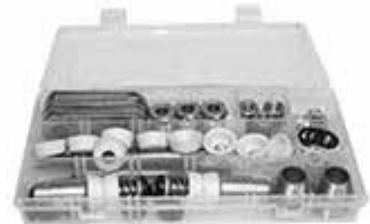

Any Flow 3/4" Flow Rates

WATER SYSTEM PRESSURE	GALLONS PER MINUTE (GPM)										
	0	5	10	15	20	25	30	35	40	45	50
20 PSI	18 GPM @ 20 PSI										
30 PSI	21 GPM @ 30 PSI										
40 PSI	24 GPM @ 40 PSI										
60 PSI	30 GPM @ 60 PSI										
80 PSI	34 GPM @ 80 PSI										
100 PSI	40 GPM @ 100 PSI										

NOTE: Most common 1/2 hp submersible pumps output is 10GPM.

Any Flow 1" Flow Rates

WATER SYSTEM PRESSURE	GALLONS PER MINUTE (GPM)												
	0	5	10	15	20	25	30	35	40	45	50	55	
10 PSI	15 GPM @ 10 PSI												
20 PSI	20 GPM @ 20 PSI												
30 PSI	26 GPM @ 30 PSI												
40 PSI	32 GPM @ 40 PSI												
60 PSI	40 GPM @ 60 PSI												
80 PSI	46 GPM @ 80 PSI												
100 PSI	54 GPM @ 100 PSI												
NOTE: Most common 1/2 hp submersible pumps output is 10GPM.													

NOTE: Most common 1/2 hp submersible pumps output is 10GPM.

Hydrants Available with Optional No Lead Vacuum Breakers

- ASSE-IAPMO Code approved and marked

- ❖ **BVBADNL75** 3/4" Hose - Brass Finish - AUTOMATIC DRAIN - No Lead
- ☆ **BVBNL75M** 3/4" Hose - Brass Finish - MANUAL DRAIN - No Lead



BVBADNL75



BVBNL75M

1) Any Flow Yard Hydrants are packaged 12 per master bundle.

2) Hydrants available with optional Red Brass or No Lead Bronze Hydrant Ells or Tees. Include number (i.e. RBHE75) after Order No.

- RBHE75** 3/4" NPT x 3/4" Plastic Pipe Elbow
- RBHE100** 3/4" NPT x 1" Plastic Pipe Elbow
- RBHEL100** 1" NPT x 3/4" Plastic Pipe Elbow (Extra Long Barbs)
- RBHE1000** 1" NPT x 1" Plastic Pipe Elbow
- RBHEL1000** 1" NPT x 1" Plastic Pipe Elbow (Extra Long Barbs)
- RBHE1025** 1-1/4" NPT x 1" Plastic Pipe Elbow
- RBHE125** 1-1/4" NPT x 1-1/4" Plastic Pipe Elbow

- ❖ **RBHENL75** No Lead 3/4" NPT x 3/4" Plastic Pipe Elbow
- ❖ **RBHENL100** No Lead 3/4" NPT x 1" Plastic Pipe Elbow
- ❖ **RBHENL1000** No Lead 1" NPT x 1" Plastic Pipe Elbow

- RBHT75** 3/4" NPT x 3/4" Plastic Pipe Tee
- RBHT7510** 3/4" NPT x 1" Plastic Pipe Tee
- RBHT1000** 1" NPT x 1" Plastic Pipe Tee

- ❖ **RBHTNL75** No Lead 3/4" NPT x 3/4" Plastic Pipe Tee
- ❖ **RBHTNL7510** No Lead 3/4" NPT x 1" Plastic Pipe Tee
- ❖ **RBHTNL1000** No Lead 1" NPT x 1" Plastic Pipe Tee



ANY FLOW

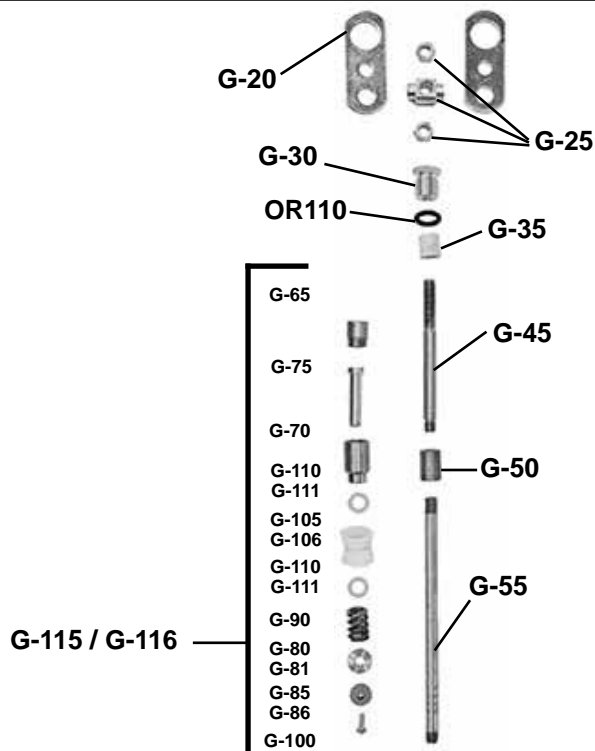

ANY FLOW 1" SIZE PARTS LIST

Order No.	UPC Bar Code (Qty. 1)	Part Description
G-2	6 42367 01513 8	Head Casting (Includes G-7 & G-35)
★ GNL-2	6 42367 42434 3	No Lead Head Casting (Includes GNL-7 & G-35)
G-6	6 42367 01543 5	Hose Thread Adapter*
G-7	6 42367 10992 9	Hose Thread Adapter**
★ GNL-7	6 42367 41985 1	No Lead Thread Adapter
G-11	6 42367 09313 6	Lever Casting
G-15	6 42367 01506 0	Lever Bolt & Nut
★ G-20	6 42367 01514 5	Draw Straps (per pair)
★ G-25	6 42367 01515 2	Pivot Connector & Nuts
★ G-30	6 42367 01522 0	Packing Nut
★ OR110	6 42367 09120 0	O-Ring
G-35	6 42367 01523 7	Valve Stem Packing
G-41	6 42367 01527 5	Valve Body
★ GNL-41	6 42367 42079 6	No Lead Valve Body
★ G-45	6 42367 01531 2	Stainless Steel Rod
G-50	6 42367 01533 6	Rod Reducer
G-55		7/16" Galvanized Rod
★ G-61		1-1/4" Galvanized Pipe
G-65	6 42367 01563 3	Plunger Bushing
G-70	6 42367 01564 0	Plunger Body
G-75	6 42367 01565 7	Plunger Bolt
G-81	6 42367 01577 0	Threaded Washer
G-86	6 42367 01579 4	3/4 Beveled Bibb Washer
★ G-90	6 42367 01580 0	Stainless Steel Spring
G-100	6 42367 01495 7	Retainer Screw
★ G-106	6 42367 01498 8	Cup Leathers (per pair)
G-111	6 42367 01501 5	Plunger Washer (per pair)
G-116	6 42367 01503 9	Plunger Assembly - Parts No. G-65, 70, 75, 81, 86, 90, 100, 106, 111
G-121	6 42367 01505 3	Head Assembly - Parts No. G-2, 6, 11, 15, 20, 25, 30, 35, 45, 50, OR110
★ GNL-121	6 42367 42435 0	No Lead Head Assembly - Parts No. GNL-2, GNL-7, G-11, 15, 20, 25, 30, 35, 45, 50, OR110
★ A-250	6 42367 07720 4	Container of Silicone Lube

C-1000 SERIES

FROST PROOF YARD HYDRANT FEATURES/BENEFITS

- * (1) **LEVER CONTROL** operates by cam principle and pulls straight up on operating rod. Provides variable flow from trickle to full flow without lock to hold lever.
BENEFIT: Variable flow with no lock that rusts in place.
- (2) **DRAW STRAPS** are made of 1040 hot rolled steel which is much harder (Brinell 175/200) and stronger. Greatly reduces wear of straps and eliminates side pull on operating rod.
BENEFIT: Longest operating life.
- * (3) **STAINLESS STEEL OPERATING ROD** is ground and polished and will not cut out packing and packing nut, like brass rod used by other companies.
BENEFIT: Best material for operating life.
- (4) **HEAVY-DUTY SOLID BRASS HOSE ADAPTER** threaded for standard 3/4" hose coupling.
BENEFIT: Standard hose fitting readily available.
- (5) **HEAVY CAST IRON HEAD** with the same design Merrill has used for over sixty years.
BENEFIT: Time-proven design takes years of abuse.
- * (6) **PIVOT CONNECTOR WITH TWO NUTS** provides simple positive adjustment and eliminates unreliable set screws used by other companies.
BENEFIT: Adjustable for years, not like rusting set screw.
- (7) **GALVANIZED PIPE** has no exposed threads subject to the weather.
BENEFIT: No exposed steel on pipe to rust.
- (8) **ONE PIECE PLUNGER** uses double seal design to assure positive shut-off even when foreign particles are present. Plunger positively opens drain to prevent freezing, and positively closes even at slow flow rates.
BENEFIT: Economical design that still closes drain hole.
- * (9) **LONG LIFE PLUNGER** is molded with ethylene propylene material that is self-lubricating and will not bond to brass valve body like rubber plunger used by other companies.
BENEFIT: Longest operating life in one piece design.
- (10) **DOUBLE BYPASS VALVE BODY** provides a large volume of water and the time-proven design used for over sixty years.
BENEFIT: High water flow with economical design.
- (11) **LOCKING EYE** on head and lever allows hydrant to be padlocked shut when not in use.
BENEFIT: Protects from wasting of water.
- (12) **SWIVEL PARTS** permit withdrawal of moving parts without digging up hydrant. Nothing in head assembly to disconnect or adjust when removing, simply unscrew entire head assembly from galvanized pipe and pull up valve stem with plunger for inspection.
BENEFIT: Very simple repair easily done at ground level.

*EXCLUSIVE MERRILL QUALITY FEATURES



Merrill C-1000 Series Yard Hydrant

Gives year 'round Water Service,
Drains Below Frost Line
When Shut Off.

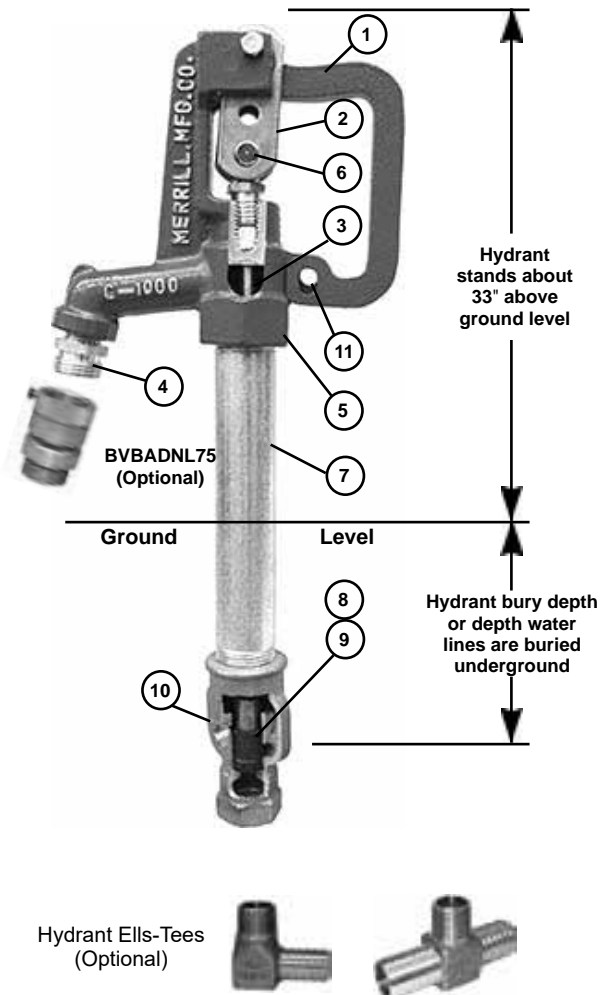

Merrill's C7504 or 4' Bury Hydrant is about 6' 8-1/2" long, 4' is buried and 33" above ground.

SPECIFICATIONS

Std. 3/4" C-1000 Series

Inlet - 3/4" NPT in Brass Casting	Teflon Packing
Outlet - 3/4" Brass Hose Thread	Brass and Molded Rubber Plunger
Stainless Steel Operating Rod	1" Galvanized Pipe

THE MERRILL C-1000 SERIES, THE MOST POPULAR AND A COMPETITIVE LINE OF YARD HYDRANTS, HAS INCORPORATED TIME-PROVEN MATERIALS AND THE SMALL DETAIL IMPROVEMENTS DISCOVERED OVER THE LAST 60 + YEARS.

☆ No Lead

❖ CA. Certified

C-1000 AND HI-CAPACITY SERIES



FROST PROOF YARD HYDRANTS STANDARD C-1000 SERIES HYDRANTS

Order No.	UPC Bar Code (Qty. 1)	Pipe Connection x Pipe Depth	Pipe Size	Overall Length	Approx. Wt./Lbs.
C7501	6 42367 00988 5	3/4" x 1' Bury	1" Galv.	44.5"	11.0
C75015	6 42367 00989 2	3/4" x 1-1/2' Bury	1" Galv.	50.5"	12.0
C7502	6 42367 00991 5	3/4" x 2' Bury	1" Galv.	56.5"	13.0
C7503	6 42367 00993 9	3/4" x 3' Bury	1" Galv.	68.5"	15.0
C7504	6 42367 00995 3	3/4" x 4' Bury	1" Galv.	80.5"	17.0
C7505	6 42367 00997 7	3/4" x 5' Bury	1" Galv.	92.5"	19.0
C7506	6 42367 00998 4	3/4" x 6' Bury	1" Galv.	104.5"	21.0
C7507	6 42367 00999 1	3/4" x 7' Bury	1" Galv.	116.5"	23.0
C7508	6 42367 01000 3	3/4" x 8' Bury	1" Galv.	128.5"	25.0
C7510	6 42367 01001 0	3/4" x 10' Bury	1" Galv.	152.5"	29.0

NOTE: The length of hydrant you need depends on the depth the water lines are buried in your area. If water lines are buried 4' you need the C7504 - 4' bury below ground with 33" above ground or 6' - 8-1/2".

C-1000 Flow Rates

WATER SYSTEM PRESSURE	GALLONS PER MINUTE (GPM)
	0 5 10 15 20 25 30 35 40 45 50
20 PSI	18 GPM @ 20 PSI
30 PSI	23 GPM @ 30 PSI
40 PSI	27 GPM @ 40 PSI
60 PSI	32 GPM @ 60 PSI
80 PSI	37 GPM @ 80 PSI
100 PSI	42 GPM @ 100 PSI

NOTE: Most common 1/2 hp submersible pumps output is 10GPM.

C-1000 Hi-Capacity Flow Rates

WATER SYSTEM PRESSURE	GALLONS PER MINUTE (GPM)
	0 5 10 15 20 25 30 35 40 45 50
10 PSI	12 GPM @ 10 PSI
20 PSI	18 GPM @ 20 PSI
30 PSI	24 GPM @ 30 PSI
40 PSI	30 GPM @ 40 PSI
60 PSI	38 GPM @ 60 PSI
80 PSI	45 GPM @ 80 PSI
100 PSI	51 GPM @ 100 PSI

NOTE: Most common 1/2 hp submersible pumps output is 10GPM.

1) C-1000 Yard Hydrants packaged 12 per master bundle.

2) Hydrants available with optional Red Brass Hydrant Ells or Tees.

Include number (i.e. RBHE75) after Order No.

RBHE75 3/4" NPT x 3/4" Plastic Pipe Elbow

RBHE100 3/4" NPT x 1" Plastic Pipe Elbow

RBHT75 3/4" NPT x 3/4" Plastic Pipe Tee

RBHT7510 3/4" NPT x 1" Plastic Pipe Tee



Hydrants Available with Optional No Lead Brass Vacuum Breakers

• ASSE-IAPMO Code approved and marked.

❖ BVBADNL75 - 3/4" Hose - Brass Finish

- AUTO DRAIN - No Lead

☆ BVBNL75M - 3/4" Hose - Brass Finish

- MANUAL DRAIN - No Lead



BVBADNL75

BVBNL75M



FROST PROOF YARD HYDRANTS STAINLESS STEEL C-1000 SERIES HYDRANTS

Order No.	UPC Bar Code (Qty. 1)	Pipe Connection x Pipe Depth	Pipe Size	Overall Length	Approx. Wt./Lbs.
CB7501	6 42367 04507 4	3/4" x 1' Bury	1" Stainless Steel	44.5"	12.0
CB75015	6 42367 04508 1	3/4" x 1-1/2' Bury	1" Stainless Steel	50.5"	13.1
CB7502	6 42367 04509 8	3/4" x 2' Bury	1" Stainless Steel	56.5"	14.3
CB7503	6 42367 04510 4	3/4" x 3' Bury	1" Stainless Steel	68.5"	16.7
CB7504	6 42367 01003 4	3/4" x 4' Bury	1" Stainless Steel	80.5"	19.0
CB7505	6 42367 04511 1	3/4" x 5' Bury	1" Stainless Steel	92.5"	21.3
CB7506	6 42367 04512 8	3/4" x 6' Bury	1" Stainless Steel	104.5"	23.7
CB7507	6 42367 04513 5	3/4" x 7' Bury	1" Stainless Steel	116.5"	26.0
CB7508	6 42367 04514 2	3/4" x 8' Bury	1" Stainless Steel	128.5"	28.3
CB7510	6 42367 04175 5	3/4" x 10' Bury	1" Stainless Steel	152.5"	33.0

Stainless Steel stand pipe and 7/16" Stainless Steel rod connecting plunger and stainless steel thru packing.

FROST PROOF YARD HYDRANTS C-1000 HI-CAPACITY

Order No.	UPC Bar Code (Qty. 1)	Pipe Connection x Pipe Depth	Pipe Size	Overall Length	Approx. Wt./Lbs.
C101	6 42367 11310 0	1" x 1' Bury	1" Galv.	44.5"	11.0
C1015	6 42367 11311 7	1" x 1-1/2' Bury	1" Galv.	50.5"	12.0
C102	6 42367 11312 4	1" x 2' Bury	1" Galv.	56.5"	13.0
C103	6 42367 11313 1	1" x 3' Bury	1" Galv.	68.5"	15.0
C104	6 42367 11314 8	1" x 4' Bury	1" Galv.	80.5"	17.0
C105	6 42367 11315 5	1" x 5' Bury	1" Galv.	92.5"	19.0
C106	6 42367 11316 2	1" x 6' Bury	1" Galv.	104.5"	21.0
C107	6 42367 11317 9	1" x 7' Bury	1" Galv.	116.5"	23.0
C108	6 42367 11318 6	1" x 8' Bury	1" Galv.	128.5"	25.0
C110	6 42367 11319 3	1" x 10' Bury	1" Galv.	152.5"	29.0

NOTE: The length of hydrant you need depends on the depth the water lines are buried in your area. If water lines are buried 4' you need the C104 - 4' bury below ground with 33" above ground or 6' - 8-1/2".

CNL-1000, CBNL-1000 & HI-CAPACITY SERIES

NO LEAD FROST PROOF YARD HYDRANT FEATURES/BENEFITS

- * (1) **LEVER CONTROL** operates by cam principle and pulls straight up on operating rod, provides variable flow from trickle to full flow without lock to hold lever.
BENEFIT: Variable flow with no lock that rusts in place.
- (2) **DRAW STRAPS** are made of 1040 hot rolled steel which is much harder (Brinell 175/200) and stronger, greatly reduces wear of straps and eliminates side pull on operating rod.
BENEFIT: Longest operating life.
- * (3) **STAINLESS STEEL OPERATING ROD** is ground and polished and will not cut out packing and packing nut, like brass rod used by other companies.
BENEFIT: Best material for longest operating life.
- (4) **HOSE ADAPTER** fits standard 3/4" hose fitting.
BENEFIT: No lead material.
- (5) **HEAVY CAST IRON HEAD** with the same design Merrill has used for over sixty years.
BENEFIT: Time-proven design takes years of abuse.
- * (6) **PIVOT CONNECTOR WITH TWO NUTS** provides simple positive adjustment and eliminates unreliable set screws used by other companies.
BENEFIT: Adjustable for years, not like rusting set screw.
- (7) **NO LEAD GALVANIZED PIPE** or **STAINLESS STEEL PIPE** has no exposed threads subject to the weather.
BENEFIT: No exposed steel on pipe to rust.
- (8) **ONE PIECE PLUNGER** uses double seal design to assure positive shut-off even when foreign particles are present. Plunger positively opens drain to prevent freezing, and positively closes even at slow flow rates.
BENEFIT: Economical design that still closes drain hole.
- * (9) **LOGLIFE PLUNGER** is molded with ethylene propylene material that is self-lubricating and will not bond to no lead brass valve body like rubber plunger used by other companies.
BENEFIT: Longest operating life in one piece design.
- (10) **NO LEAD BRASS DOUBLE BYPASS VALVE BODY** provides a large volume of water and the time-proven design used for over sixty years.
BENEFIT: High water flow with economical design.
- (11) **LOCKING EYE** on head and lever allows hydrant to be padlocked shut when not in use.
BENEFIT: Protects from waste of water.
- * (12) **SWIVEL PARTS** permit withdrawal of moving parts without digging up hydrant. Nothing in head assembly to disconnect or adjust when removing, simply unscrew entire head assembly from galvanized pipe and pull up valve stem with plunger for inspection.
BENEFIT: Very simple repair easily done at ground level.

*EXCLUSIVE MERRILL QUALITY FEATURES

Merrill CNL-1000 and CBNL-1000 Series

Gives year 'round water service that drains below frost line when shut off.

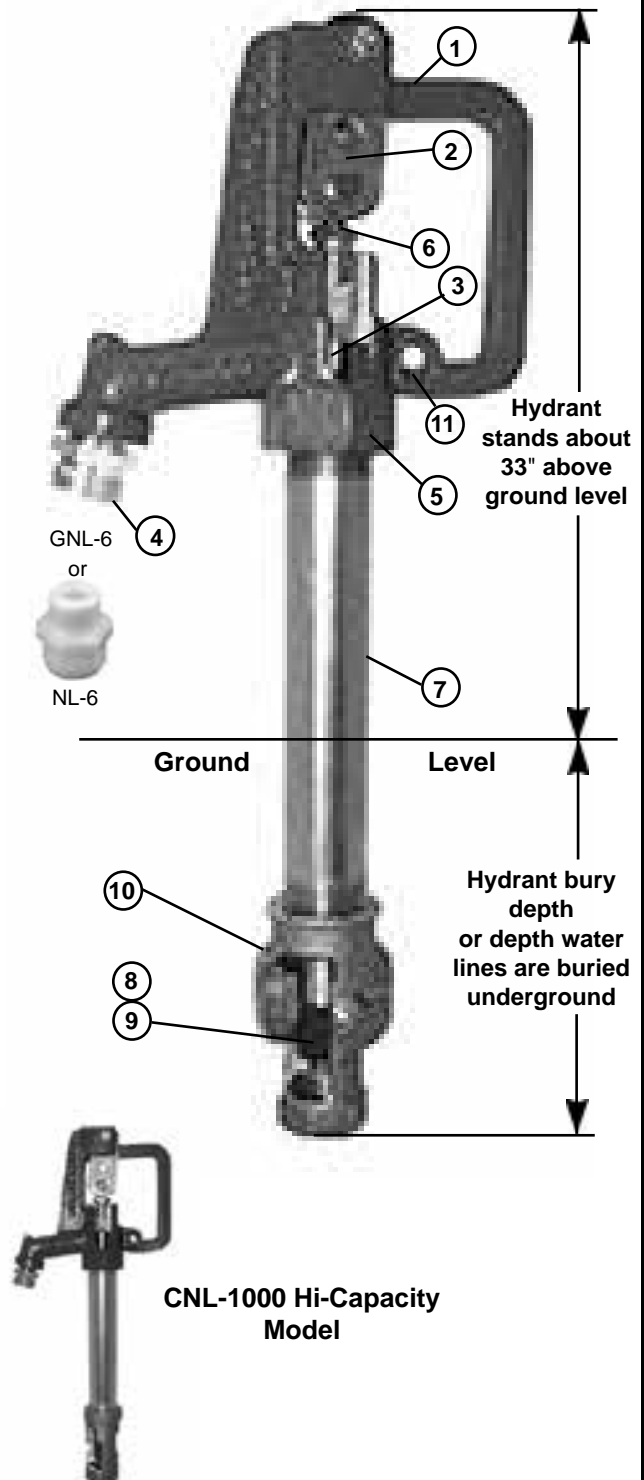

CNL-1000, CBNL-1000 & HI-CAPACITY SERIES

NO LEAD CNL-1000 SERIES HYDRANTS

Order No.	UPC Bar Code (Qty. 1)	Pipe Connection x Pipe Depth	Pipe Size	Overall Length	Approx. Wt./Lbs.
☆ CNL7501	6 42367 10872 4	3/4" x 1' Bury	1" Galvanized	44.5"	11.0
☆ CNL75015	6 42367 10903 5	3/4" x 1-1/2' Bury	1" Galvanized	50.5"	12.0
☆ CNL7502	6 42367 10873 1	3/4" x 2' Bury	1" Galvanized	56.5"	13.0
☆ CNL7503	6 42367 10874 8	3/4" x 3' Bury	1" Galvanized	68.5"	15.0
☆ CNL7504	6 42367 10875 5	3/4" x 4' Bury	1" Galvanized	80.5"	17.0
☆ CNL7505	6 42367 10881 6	3/4" x 5' Bury	1" Galvanized	92.5"	19.0
☆ CNL7506	6 42367 10882 3	3/4" x 6' Bury	1" Galvanized	104.5"	21.0
☆ CNL7507	6 42367 10883 0	3/4" x 7' Bury	1" Galvanized	116.5"	23.0
☆ CNL7508	6 42367 10904 2	3/4" x 8' Bury	1" Galvanized	128.5"	25.0
☆ CNL7510	6 42367 10905 9	3/4" x 10' Bury	1" Galvanized	152.5"	29.0

NOTE: The length of hydrant you need depends on the depth the water lines are buried in your area. If water lines are buried 4' you need the CNL7504 - 4' bury below ground with 33" above ground or 6'- 8-1/2".

NO LEAD HI-CAPACITY CNL-1000 SERIES HYDRANTS

Order No.	UPC Bar Code (Qty. 1)	Pipe Connection x Pipe Depth	Pipe Size	Overall Length	Approx. Wt./Lbs.
☆ CNL101	6 42367 42111 3	1" x 1' Bury	1" Galvanized	44.5"	11.0
☆ CNL1015	6 42367 42112 0	1" x 1-1/2' Bury	1" Galvanized	50.5"	12.0
☆ CNL102	6 42367 42043 7	1" x 2' Bury	1" Galvanized	56.5"	13.0
☆ CNL103	6 42367 42042 0	1" x 3' Bury	1" Galvanized	68.5"	15.0
☆ CNL104	6 42367 42044 4	1" x 4' Bury	1" Galvanized	80.5"	17.0
☆ CNL105	6 42367 42045 1	1" x 5' Bury	1" Galvanized	92.5"	19.0
☆ CNL106	6 42367 42113 7	1" x 6' Bury	1" Galvanized	104.5"	21.0
☆ CNL107	6 42367 42114 4	1" x 7' Bury	1" Galvanized	116.5"	23.0
☆ CNL108	6 42367 42115 1	1" x 8' Bury	1" Galvanized	128.5"	25.0
☆ CNL110	6 42367 42116 8	1" x 10' Bury	1" Galvanized	152.5"	29.0

NO LEAD CBNL-1000 SERIES HYDRANTS

Order No.	UPC Bar Code (Qty. 1)	Pipe Connection x Pipe Depth	Pipe Size	Overall Length	Approx. Wt./Lbs.
☆ CBNL7501	6 42367 41792 5	3/4" x 1' Bury	1" Stainless Steel	44.5"	12.0
☆ CBNL7502	6 42367 41793 2	3/4" x 2' Bury	1" Stainless Steel	56.5"	14.3
☆ CBNL7503	6 42367 41794 9	3/4" x 3' Bury	1" Stainless Steel	68.5"	16.7
☆ CBNL7504	6 42367 41795 6	3/4" x 4' Bury	1" Stainless Steel	80.5"	19.0
☆ CBNL7505	6 42367 41796 3	3/4" x 5' Bury	1" Stainless Steel	92.5"	21.3
☆ CBNL7506	6 42367 41797 0	3/4" x 6' Bury	1" Stainless Steel	104.5"	23.7
☆ CBNL7507	6 42367 41798 7	3/4" x 7' Bury	1" Stainless Steel	116.5"	26.0
☆ CBNL7508	6 42367 41799 4	3/4" x 8' Bury	1" Stainless Steel	128.5"	28.3
☆ CBNL7510	6 42367 41800 7	3/4" x 10' Bury	1" Stainless Steel	152.5"	33.0

Stainless Steel Stand Pipe and 7/16" stainless steel rod connecting plunger and stainless steel thru packing.

NO LEAD HI CAPACITY CBNL-1000 SERIES HYDRANTS

Order No.	UPC Bar Code (Qty. 1)	Pipe Connection x Pipe Depth	Pipe Size	Overall Length	Approx. Wt./Lbs.
☆ CBNL101	6 42367 43468 7	1" x 1' Bury	1" Stainless Steel	44.5"	12.0
☆ CBNL102	6 42367 43285 0	1" x 2' Bury	1" Stainless Steel	56.5"	14.3
☆ CBNL103	6 42367 43469 4	1" x 3' Bury	1" Stainless Steel	68.5"	16.7
☆ CBNL104	6 42367 43470 0	1" x 4' Bury	1" Stainless Steel	80.5"	19.0
☆ CBNL105	6 42367 43413 7	1" x 5' Bury	1" Stainless Steel	92.5"	21.3
☆ CBNL106	6 42367 43471 7	1" x 6' Bury	1" Stainless Steel	104.5"	23.7
☆ CBNL107	6 42367 43472 4	1" x 7' Bury	1" Stainless Steel	116.5"	26.0
☆ CBNL108	6 42367 43473 1	1" x 8' Bury	1" Stainless Steel	128.5"	28.3
☆ CBNL110	6 42367 43474 8	1" x 10' Bury	1" Stainless Steel	152.5"	33.0

Stainless Steel Stand Pipe and 7/16" stainless steel rod connecting plunger and stainless steel thru packing.



CNL-1000 Model



CNL-1000 Hi-Capacity Model

☆ No Lead

C-1000 & CNL-1000 SERIES PARTS

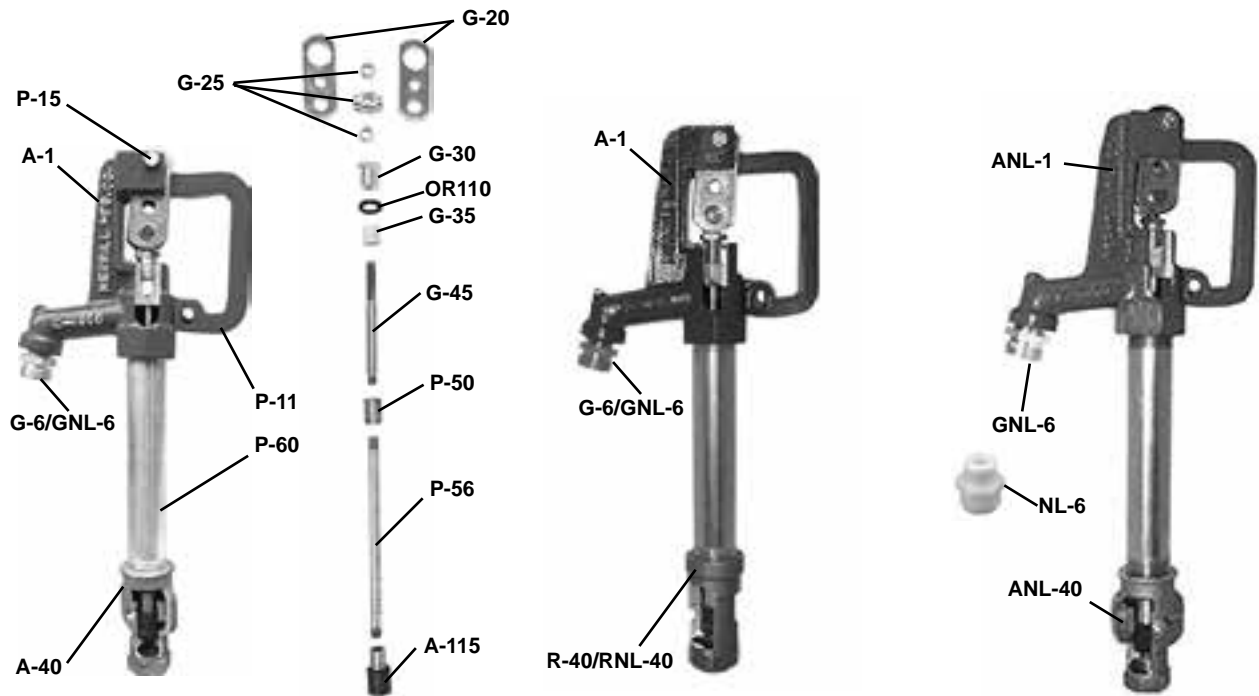

C-1000 Series Parts List

Part No.	UPC Bar Code (Qty. 1)	Part Description
☆ A-1	6 42367 00715 7	Head Casting (Includes G-6 & G-35)
☆ G-6	6 42367 01543 5	Hose Thread Adapter
☆ GNL-6	6 42367 41048 3	No Lead Hose Thread Adapter
☆ P-11	6 42367 09296 2	Lever Casting
☆ P-15	6 42367 01985 3	Lever Bolt & Nut
☆ G-20	6 42367 01514 5	Draw Straps (Per Pr.)
☆ G-25	6 42367 01515 2	Pivot Connector & Nuts
☆ G-30	6 42367 01522 0	Packing Nut
☆ OR110	6 42367 09120 0	O-Ring
☆ G-35	6 42367 01523 7	Valve Stem Packing
☆ A-40	6 42367 00723 2	3/4" Valve Body
☆ R-40	6 42367 11309 4	1" Valve Body
☆ G-45	6 42367 01531 2	Stainless Steel Rod
☆ P-50	6 42367 01994 5	Rod Connector
☆ P-56		3/8" Operating Rod
☆ P-60		1" No Lead Galv. Pipe
☆ A-115	6 42367 00717 1	Plunger
☆ A-121	6 42367 00720 1	Head Assembly
		Parts No. A-1, G-6, 20, 25, 30, 35, 45, OR110, P-11, 15, 50
☆ A-250	6 42367 07720 4	Container of Silicone Lube

CNL-1000 No Lead Series Parts List

Part No.	UPC Bar Code (Qty. 1)	Part Description
☆ ANL-1	6 42367 11064 2	Head Casting (Includes GNL-6 & G-35)
☆ NL-6	6 42367 10876 2	Nylon Hose Adapter
☆ GNL-6	6 42367 41048 3	No Lead Hose Thread Adapter
☆ P-11	6 42367 09296 2	Lever Casting
☆ P-15	6 42367 01985 3	Lever Bolt & Nut
☆ G-20	6 42367 01514 5	Draw Straps (Per Pr.)
☆ G-25	6 42367 01515 2	Pivot Connector & Nuts
☆ G-30	6 42367 01522 0	Packing Nut
☆ OR110	6 42367 09120 0	O-Ring
☆ G-35	6 42367 01523 7	Valve Stem Packing
☆ ANL-40	6 42367 10901 1	3/4" No Lead Valve Body
☆ RNL-40	6 42367 41780 2	1" No Lead Valve Body
☆ G-45	6 42367 01531 2	Stainless Steel Rod
☆ P-50	6 42367 01994 5	Rod Connector
☆ P-56		3/8" Operating Rod
☆ P-60		1" No Lead Galv. Pipe
☆ A-115	6 42367 00717 1	Plunger
☆ ANL-121	6 42367 10902 8	Head Assembly
		Parts No. ANL-1, GNL-6, OR110, G-20, 25, 30, 35, 45, P-11, 15, 50
☆ A-250	6 42367 07720 4	Container of Silicone Lube

PARTS KIT "CP" CONTAINS

Qty.	Part No.
1	G-35
1	A-115
1	A-250
1	OR110

ORDER NO. PKCP
UPC Bar Code (Qty. 1)
6 42367 06513 3

PARTS KIT "CF" CONTAINS

Qty.	Part No.
1 Pr.	G-20
1	G-25
1	G-30
1	G-35
1	A-115
1	OR110

ORDER NO. PKCF
UPC Bar Code (Qty. 1)
6 42367 02216 7

PARTS KIT "C" CONTAINS

Qty.	Part No.
3 Pr.	G-20
2	G-25
3	G-30
3	G-35
1	G-45
3	P-50
3	A-115
3	OR110

ORDER NO. PKC
UPC Bar Code (Qty. 1)
6 42367 02215 0

Imported China Frost Proof Yard Hydrant Replacement Parts List*

MHCYHC

Complete Head Assembly

Bar Code (Qty.1)
6 42367 10145 9

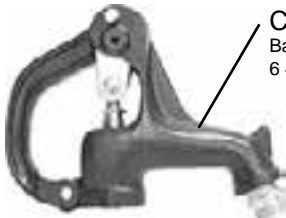

MHCYHH

Handle Casting

Bar Code (Qty.1)
6 42367 10147 3



MHCYHHD

Head Casting

Bar Code (Qty.1)
6 42367 10148 0



MHCYHBA

Lower Valve Assembly

Bar Code (Qty.1)
6 42367 10144 2



MHCYHP

Valve Plunger

Bar Code (Qty.1)
6 42367 10151 0



MHCYHCR

Clevis Rod

Bar Code (Qty.1)
6 42367 10146 6



MHCYRK1

Repair Kit

Bar Code (Qty.1)
6 42367 10564 8



**Low Quality
Product Sold By
Others**

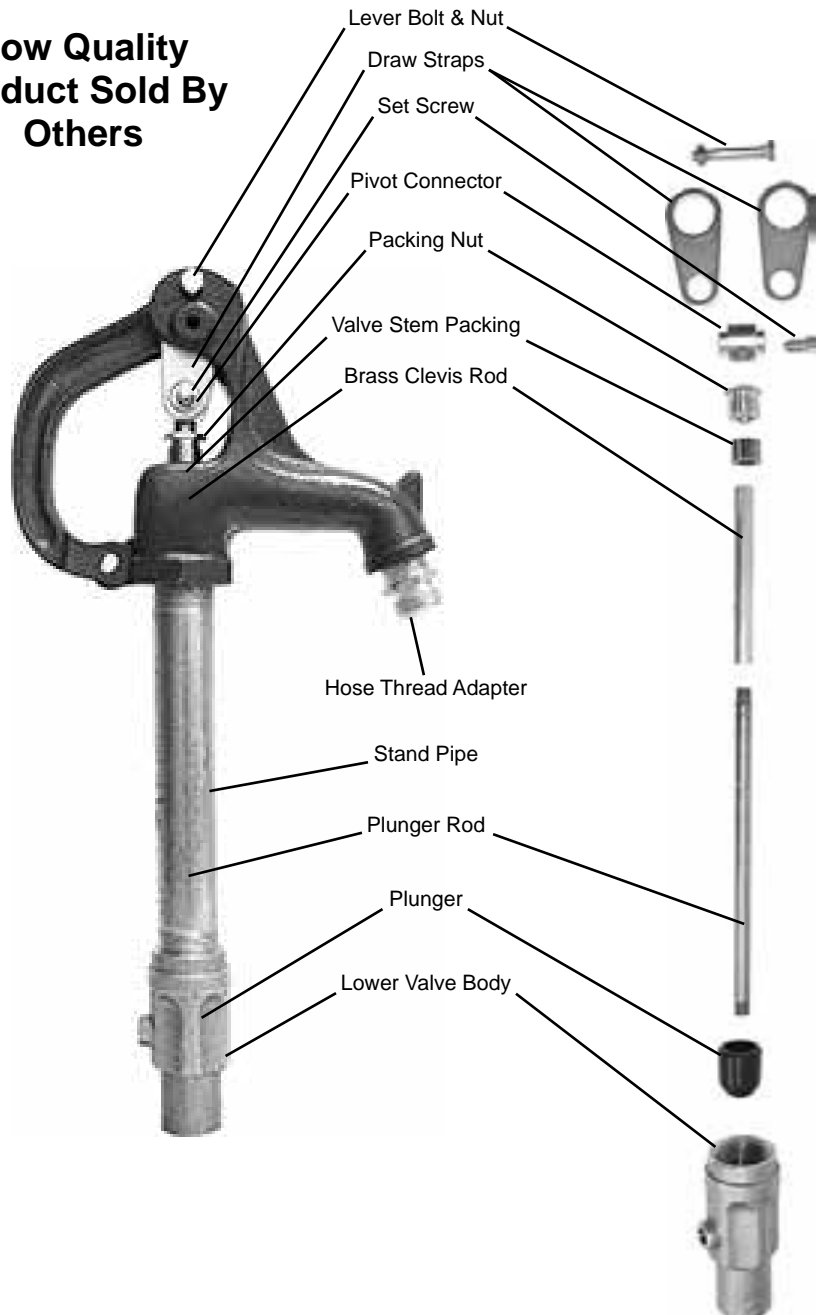

An Extra Merrill Customer Service.

We have competitors (low end) Yard Hydrant Parts in stock for repair needs on old hydrants - eliminate your parts problems and buy only quality Merrill Yard Hydrants.

R-6000 & RNL-6000 SERIES

FROST PROOF YARD HYDRANT FEATURES/BENEFITS

- (1) **HEAVY CAST IRON HEAD** with full flow design
BENEFIT: Stands up to abuse and has high flow rate
- (2) **DRAW STRAPS** are made of 1040 hot rolled steel which is much harder (Brinell 175/200) and stronger, greatly reduces wear of straps and eliminates side pull on operating rod.
BENEFIT: Longest operating life.
- (3) **HEAVY CAST IRON HANDLE**
BENEFIT: Easy to grip and longer life
- (4) **ROCKER ARM AND OPERATING ROD WITH TWO NUTS** provides simple positive adjustment and eliminates unreliable set screws used by other companies.
BENEFIT: Adjustable for years, not like rusting set screw.
- (5) **EASY TO ADJUST** stainless steel operating rod
BENEFIT: Longest life - Quality material
- (6) **PACKING GLAND WITH TEFLON® PACKING**
BENEFIT: Non-corrosive packing gland with longest lasting packing - A better quality packing than used by others. Teflon® a Dupont Product
- (7) **EASY PLUNGER REPLACEMENT** by removing packing gland and lifting out plunger thru head assembly - No need to unscrew head from riser pipe
BENEFIT: Quick plunger replacement
- (8) **SCHEDULE 40 GALVANIZED RISER PIPE**
BENEFIT: Long lasting riser pipe
- (9) **1" VALVE INLET SIZE**
BENEFIT: Easy installation and better flow rate
- (10) **ONE PIECE MOLDED PLUNGER WITH LUBRICANT** uses double seal design to assure positive shut-off even when foreign particles are present. Plunger positively opens drain to prevent freezing, and positively closes drain even at slow flow rates.
BENEFIT: Economical design that still closes drain hole before flow starts.
- (11) **LONG LIFE PLUNGER** is molded with ethylene propylene material that is self-lubricating and will not bond to valve body like rubber plunger used by other companies.
BENEFIT: Longest operating life in one piece design.
- (12) **DOUBLE BYPASS VALVE BODY** provides a large volume of water and the time-proven design used for over sixty years.
BENEFIT: High water flow with economical design.
- (13) **HOSE THREAD ADAPTER**

NOTE: Hydrant available painted in Red or Yellow

Industries Best - 60 plus years - Proven Performer

Merrill R-6000/RNL-6000 Series Frost Proof Yard Hydrant

Gives year 'round water service that drains below the frost line when shut off.

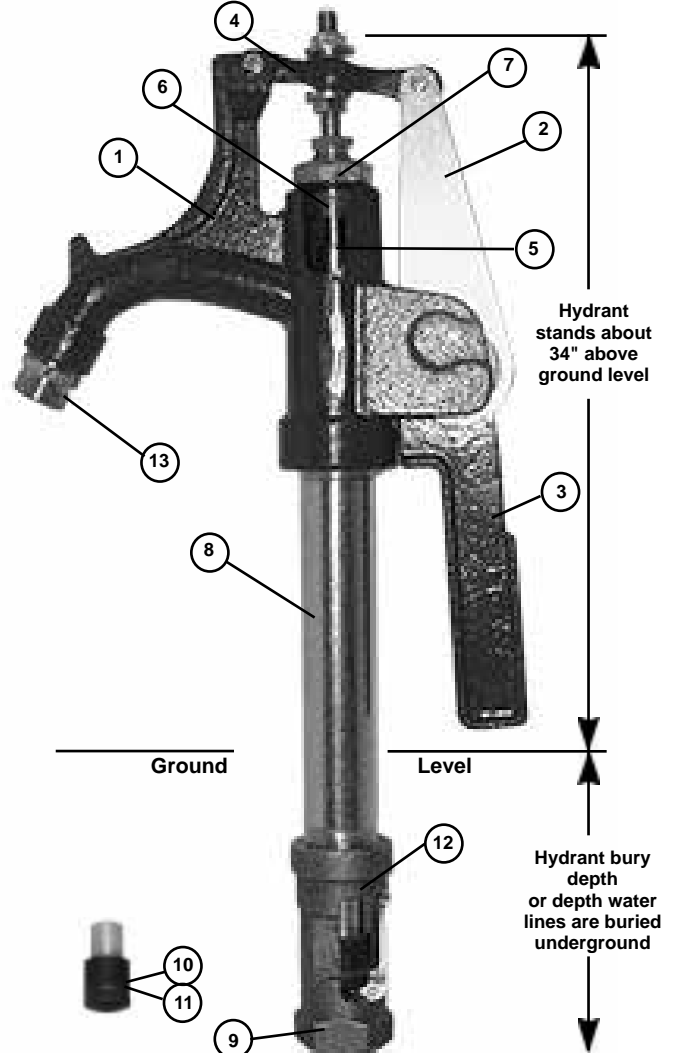

SPECIFICATIONS

R-6000/RNL-6000 Series Yard Hydrant

Inlet - 1" NPT
Outlet - 3/4" Hose Thread Adapter
Stainless Steel Operating Rod
Teflon® Packing
1" Galvanized Pipe

Heavy Cast Iron Head
Heavy Cast Valve Body with two flow ways
Molded Rubber Plunger made of self-lubricating material

R-6000/RNL-6000 Hydrant Flow Rates

WATER SYSTEM PRESSURE	GALLONS PER MINUTE (GPM)										
	0	5	10	15	20	25	30	35	40	45	50
20 PSI	20 GPM @ 20 PSI										
30 PSI	25 GPM @ 30 PSI										
40 PSI	30 GPM @ 40 PSI										
60 PSI	40 GPM @ 60 PSI										
80 PSI	48 GPM @ 80 PSI										
100 PSI	53 GPM @ 100 PSI										

NOTE: Most common 1/2 hp submersible pump output is 10GPM.

- ☆ No Lead
❖ CA. Certified

R-6000 & RNL-6000 SERIES

STANDARD R-6000 SERIES FROST PROOF HYDRANTS

Order No.	UPC Bar Code (Qty. 1)	Pipe Connection x Pipe Depth	Pipe Size	Overall Length	Approx. Wt./Lbs.
R101	6 42367 11763 4	1" x 1' Bury	1" Galv.	46.5"	13.5
R1015	6 42367 11764 1	1" x 1-1/2' Bury	1" Galv.	52.5"	14.5
R102	6 42367 11765 8	1" x 2' Bury	1" Galv.	58.5"	15.5
R103	6 42367 11766 5	1" x 3' Bury	1" Galv.	70.5"	17.5
R104	6 42367 11767 2	1" x 4' Bury	1" Galv.	82.5"	19.5
R105	6 42367 11768 9	1" x 5' Bury	1" Galv.	94.5"	21.5
R106	6 42367 11769 6	1" x 6' Bury	1" Galv.	105.5"	23.5
R107	6 42367 11770 2	1" x 7' Bury	1" Galv.	117.5"	25.5
R108	6 42367 11771 9	1" x 8' Bury	1" Galv.	130.5"	27.5
R110	6 42367 11772 6	1" x 10' Bury	1" Galv.	154.5"	31.5

NOTE: The length of hydrant you need depends on the depth the water lines are buried in your area. If water lines are buried 4' you need the R104 - 4' bury below ground with 34" above ground or 6' - 9-1/2".

NO LEAD RNL-6000 SERIES FROST PROOF HYDRANTS

Order No.	UPC Bar Code (Qty. 1)	Pipe Connection x Pipe Depth	Pipe Size	Overall Length	Approx. Wt./Lbs.
☆ RNL101	6 42367 41781 9	1" x 1' Bury	1" Galv.	46.5"	13.5
☆ RNL1015	6 42367 41790 1	1" x 1-1/2' Bury	1" Galv.	52.5"	14.5
☆ RNL102	6 42367 41782 6	1" x 2' Bury	1" Galv.	58.5"	15.5
☆ RNL103	6 42367 41783 3	1" x 3' Bury	1" Galv.	70.5"	17.5
☆ RNL104	6 42367 41784 0	1" x 4' Bury	1" Galv.	82.5"	19.5
☆ RNL105	6 42367 41785 7	1" x 5' Bury	1" Galv.	94.5"	21.5
☆ RNL106	6 42367 41786 4	1" x 6' Bury	1" Galv.	105.5"	23.5
☆ RNL107	6 42367 41787 1	1" x 7' Bury	1" Galv.	117.5"	25.5
☆ RNL108	6 42367 41788 8	1" x 8' Bury	1" Galv.	130.5"	27.5
☆ RNL110	6 42367 41789 5	1" x 10' Bury	1" Galv.	154.5"	31.5

NOTE: The length of hydrant you need depends on the depth the water lines are buried in your area. If water lines are buried 4' you need the RNL104 - 4' bury below ground with 34" above ground or 6' - 9-1/2".

PARTS LIST

Part No.	UPC Bar Code (Qty. 1)	Part Description
☆ 11534M	6 42367 11355 1	Head Casting (Includes G-35)
☆ 11535M	6 42367 11328 5	Rocker Arm
☆ 12482M	6 42367 11327 8	Lever Arm
G-6	6 42367 11756 6	Hose Thread Adapter
☆ GNL-6	6 42367 41048 3	No Lead Hose Thread Adapter
☆ R-20	6 42367 11757 3	Draw Straps (Per Pr.)
G-25A	6 42367 11774 0	3/8" Jam Nut
☆ 3/8washer	6 42367 11773 3	3/8" Washer (2 each)
☆ G-45	6 42367 11758 0	Stainless Steel Operating Rod
R-40	6 42367 11759 7	Brass Valve Body
❖ RNL-40	6 42367 41780 2	No Lead Brass Valve Body
☆ G-30	6 42367 01522 0	Packing Nut
☆ OR110	6 42367 09120 0	O-Ring
☆ G-35	6 42367 01523 7	Valve Stem Packing
R-31	6 42367 11760 3	Packing Gland
☆ OR215	6 42367 09461 4	O-Ring
☆ P-50	6 42367 01994 5	Steel Rod Connector
☆ R-56		3/8" Operating Rod
☆ P-60		Galvanized Pipe
☆ 11390	6 42367 11098 7	Pivot Pin (2 each)
☆ R-15	6 42367 11776 4	Pivot Pin (1 each)
☆ 11383	6 42367 11099 4	Retainer Clip (3 each)
☆ R-50S	6 42367 11761 0	Sleeve
☆ A-115	6 42367 10212 8	Plunger
R-121	6 42367 11762 7	Complete Head Assembly - G-6, 11534M, R-31, 11390(2), 11535M, R-20(2), G-25A(2), G-30, G-35, G-45, R-15, 12482M, 11383(3), R-50S, P-50, 3/8washer(2), OR215, OR110
☆ RNL-121	6 42367 42436 7	Complete No Lead Head Assembly - GNL-6, 11534M, R-31, 11390(2), 11535M, R-20(2), G-25A(2), G-30, G-35, G-45, R-15, 12482M, 11383(3), R-50S, P-50, 3/8washer(2), OR215, OR110
R-121R	6 42367 12641 4	Complete Head Assembly Ritchie® Hydrants - G-6, 11534M, R-31, 11390(2), 11535M, R-20(2), G-30, G-35, R-15, 12482M, 11383(3), R-50S, 3/8washer(2), OR215, OR110

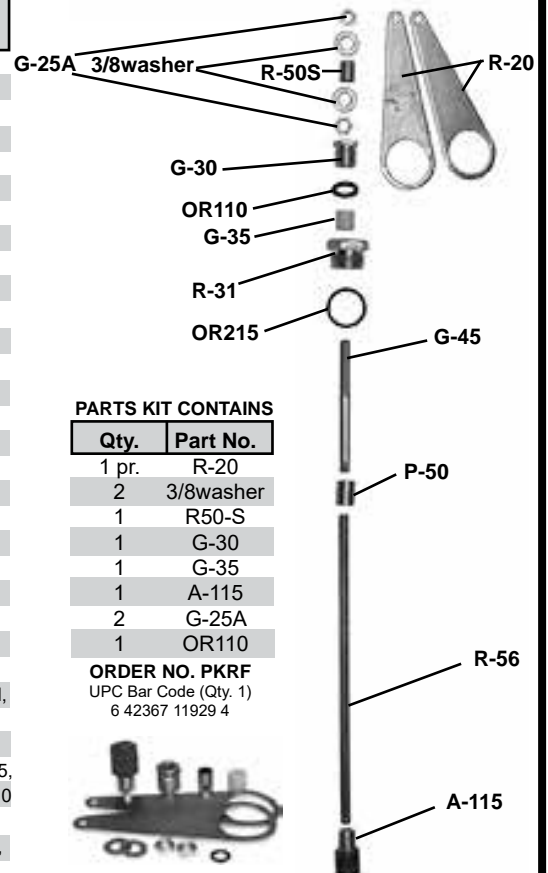
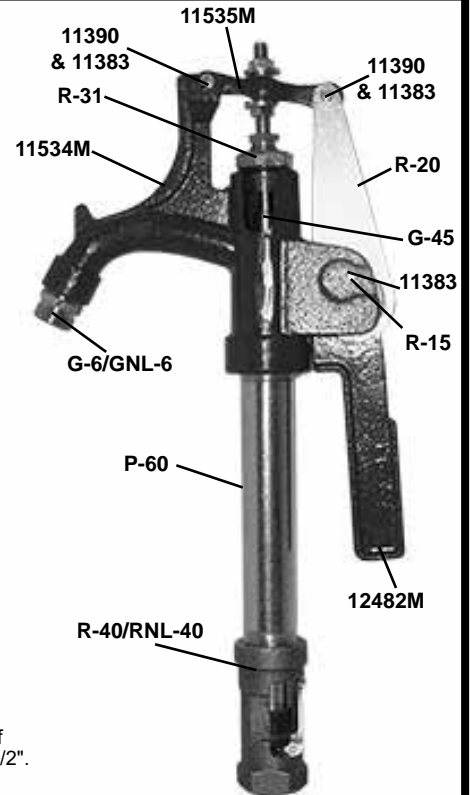

PARTS KIT CONTAINS

Qty.	Part No.
1 pr.	R-20
2	3/8washer
1	R50-S
1	G-30
1	G-35
1	A-115
2	G-25A
1	OR110

ORDER NO. PKRF
UPC Bar Code (Qty. 1)
6 42367 11929 4



M-2000 SERIES

FROST PROOF YARD HYDRANT

FEATURES/BENEFITS

- * (1) **LEVER CONTROL** operates by cam principle and pulls straight on operating rod. Provides variable flow from trickle to full flow without lock to hold lever.
BENEFIT: Variable flow with no lock that can rust in place.
- (2) **DRAW STRAPS** are made of 1040 hot rolled steel which is much harder (Brinell 175/200) and stronger. Greatly reduces wear of straps and eliminates side pull on operating rod.
BENEFIT: Longest operating life.
- * (3) **STAINLESS STEEL OPERATING ROD** is ground and polished and will not cut out packing and packing nut, like brass rod used by other companies.
BENEFIT: Best material for operating life.
- * (4) **FIBER REINFORCED THERMOPLASTIC HEAD** greatly reduces breakage of brittle cast iron, eliminates machining, painting and corrosion. Provides consistent, precise parts and a long life. Made of Zytel® ST (supertough) by DuPont, one of the "World's Toughest Thermoplastic"
BENEFIT: Time proven design takes years of abuse.
- * (5) **NOZZLE ON HEAD** has standard 3/4" hose thread molded on the outside and has 3/8" NPT thread molded into the inside, or an optional hose adapter is available.
BENEFIT: Standard hose fitting thread.
- * (6) **PIVOT CONNECTOR WITH TWO NUTS** provides simple positive adjustment and eliminates unreliable set screws used by other companies.
BENEFIT: Adjustable for years, not like rusted in set screws.
- (7) **GALVANIZED PIPE** has no exposed threads subject to the weather.
BENEFIT: No exposed steel on pipe to rust.
- (8) **ONE PIECE PLUNGER** uses double seal design to assure positive shut-off even when foreign particles are present. Plunger positively opens drain to prevent freezing, and positively closes even at slow flow rates.
BENEFIT: Economical design that still opens and closes drain hole.
- * (9) **LONG LIFE PLUNGER** is molded with ethylene propylene material that is self-lubricating and will not bond to brass valve body like rubber plunger used by other companies.
BENEFIT: Longest operating life in one piece design.
- * (10) **HEAVY-DUTY CELCON® VALVE BODY** eliminates corrosion in any water condition and provides a long life. Celcon® has been used in similar parts for over 40 years.
BENEFIT: High water flow with economical design.
- (11) **LOCKING EYE** on head and lever allows hydrant to be padlocked shut when not in use.
BENEFIT: Protects from wasting of water.
- * (12) **SWIVEL PARTS** permit withdrawal of moving parts without digging up hydrant. Nothing in head assembly to disconnect or adjust when removing, simply unscrew entire head assembly from galvanized pipe and pull up valve stem with plunger for inspection.
BENEFIT: Very simple repair easily done at ground level.

*EXCLUSIVE MERRILL QUALITY FEATURES



Merrill M-2000 Series Frost Proof Yard Hydrant

Gives year 'round water service that drains below the frost line when shut off.

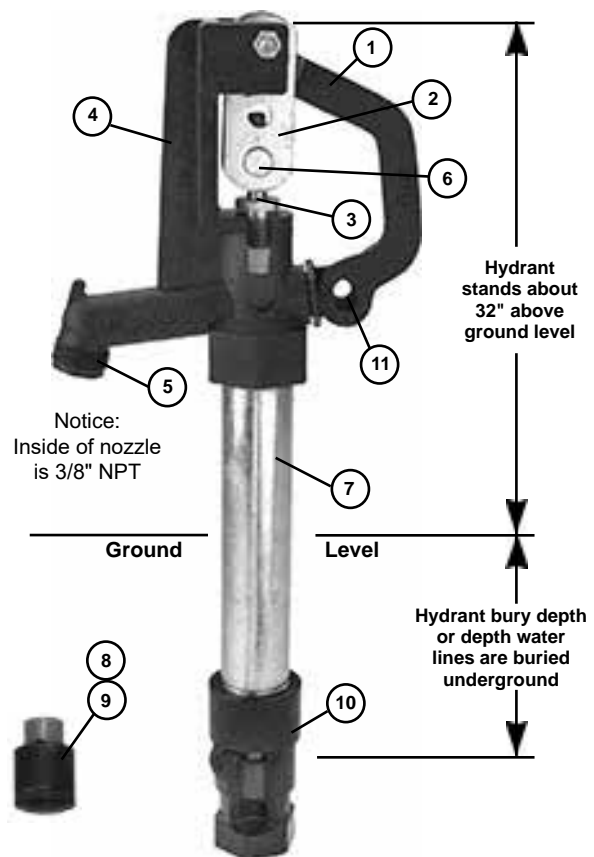

Merrill's MP7504 or 4' bury hydrant is 6' - 8' long, 4' is buried and 32" above ground.

SPECIFICATIONS

M-2000 Series Yard Hydrant

Inlet - 3/4" NPT
Outlet - 3/4" Brass Hose Thread
Stainless Steel Operating Rod
Teflon Packing
1" Galvanized Pipe

Zytel® ST Supertough Nylon Head
Celcon® Valve Body
Molded Rubber Plunger made of self-lubricating material

- ☆ No Lead
❖ CA. Certified

M-2000 SERIES

PARTS LIST

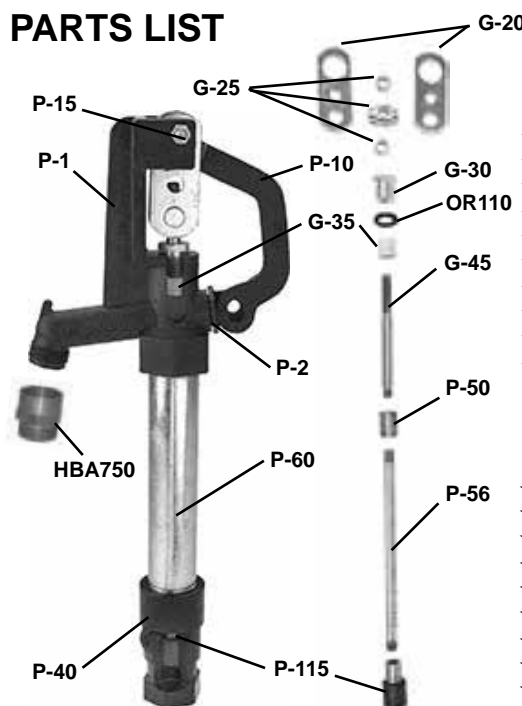

FROST PROOF YARD HYDRANTS STANDARD M-2000 SERIES HYDRANTS (NO-LEAD)

Order No.	UPC Bar Code (Qty. 1)	Pipe Connection x Pipe Depth	Pipe Size	Overall Length	Approx. Wt./Lbs.
☆MP7501	6 42367 01930 3	3/4" x 1' Bury	1" Galv.	44"	8.0
☆MP75015	6 42367 04460 2	3/4" x 1-1/2' Bury	1" Galv.	50"	9.0
☆MP7502	6 42367 01932 7	3/4" x 2' Bury	1" Galv.	56"	10.0
☆MP7503	6 42367 01934 1	3/4" x 3' Bury	1" Galv.	68"	12.0
☆MP7504	6 42367 01936 5	3/4" x 4' Bury	1" Galv.	80"	14.0
☆MP7505	6 42367 01938 9	3/4" x 5' Bury	1" Galv.	92"	16.0
☆MP7506	6 42367 01940 2	3/4" x 6' Bury	1" Galv.	104"	18.0
☆MP7507	6 42367 01942 6	3/4" x 7' Bury	1" Galv.	116"	20.0
☆MP7508	6 42367 01944 0	3/4" x 8' Bury	1" Galv.	128"	22.0
☆MP7510	6 42367 01946 4	3/4" x 10' Bury	1" Galv.	152"	25.0

M-2000 SERIES WITH HOSE ADAPTER

Order No.	UPC Bar Code (Qty. 1)	Pipe Connection x Pipe Depth	Pipe Size	Overall Length	Approx. Wt./Lbs.
☆MP7501A	6 42367 01931 0	3/4" x 1' Bury	1" Galv.	44"	8.0
☆MP75015A	6 42367 04459 6	3/4" x 1-1/2' Bury	1" Galv.	50"	9.0
☆MP7502A	6 42367 01933 4	3/4" x 2' Bury	1" Galv.	56"	10.0
☆MP7503A	6 42367 01935 8	3/4" x 3' Bury	1" Galv.	68"	12.0
☆MP7504A	6 42367 01937 2	3/4" x 4' Bury	1" Galv.	80"	14.0
☆MP7505A	6 42367 01939 6	3/4" x 5' Bury	1" Galv.	92"	16.0
☆MP7506A	6 42367 01941 9	3/4" x 6' Bury	1" Galv.	104"	18.0
☆MP7507A	6 42367 01943 3	3/4" x 7' Bury	1" Galv.	116"	20.0
☆MP7508A	6 42367 01945 7	3/4" x 8' Bury	1" Galv.	128"	22.0
☆MP7510A	6 42367 05655 1	3/4" x 10' Bury	1" Galv.	152"	25.0

NOTE: The length of hydrant you need depends on the depth the water lines are buried in your area. If water lines are buried 4' you need the MP7504 - 4' bury below ground 32" above ground or 6'-8' total length.

Part No.	UPC Bar Code (Qty. 1)	Part Description
----------	-----------------------	------------------

☆P-1	6 42367 01978 5	Head
☆P-2	6 42367 01988 4	Head Plug
HBA750	6 42367 01682 1	Hose Adapter (optional)
☆P-10	6 42367 01979 2	Lever Casting
☆P-15	6 42367 01985 3	Lever Bolt & Nut
☆G-20	6 42367 01514 5	Draw Straps (Per Pr.)
☆G-25	6 42367 01515 2	Pivot Connector & Nuts
☆G-30	6 42367 01522 0	Packing Nut
☆OR110	6 42367 09120 0	O-Ring
☆G-35	6 42367 01523 7	Valve Stem Packing
☆P-40	6 42367 01992 1	Valve Body
☆G-45	6 42367 01531 2	Stainless Steel Rod
☆P-50	6 42367 01994 5	Steel Connector
☆P-60		1" Galv. Pipe
☆P-56		3/8" Operating Rod
☆P-115	6 42367 01982 2	Plunger
☆P-120	6 42367 01984 6	Head Assembly
		Parts No. P-1, 2, 10, 15, 50
		G-20, 25, 30, 35, 45, OR110
☆A-250	6 42367 07720 4	Container of Silicone Lube

PARTS KIT "MP" CONTAINS

Qty.	Part No.
1	G-35
1	P-115
1	A-250
1	OR110

ORDER NO. PKMP
UPC Bar Code (Qty. 1)
6 42367 08819 4

PARTS KIT "PF" CONTAINS

Qty.	Part No.
1 Pr.	G-20
1	G-25
1	G-30
1	G-35
1	P-115
1	OR110

ORDER NO. PKPF
UPC Bar Code (Qty. 1)
6 42367 02217 4

PARTS KIT "B" CONTAINS

Qty.	Part No.
3 Pr.	G-20
2	G-25
3	G-30
3	G-35
2	G-45
3	P-50
3	P-115
3	OR110

ORDER NO. PKB
UPC Bar Code (Qty. 1)
6 42367 02214 3



1) M-2000 Yard Hydrants packaged 12 per master bundle.

2) Hydrants available with optional Red Brass or No Lead Bronze Hydrant Elbows and Tees. Include number (i.e. RBHE75) after Order No.

- RBHE75 3/4" NPT x 3/4" Plastic Pipe Elbow
- RBHE100 3/4" NPT x 1" Plastic Pipe Elbow
- RBHT75 3/4" NPT x 3/4" Plastic Pipe Tee
- RBHT7510 3/4" NPT x 1" Plastic Pipe Tee
- ❖RBHENL75 No Lead 3/4" NPT x 3/4" Plastic Pipe Elbow
- ❖RBHENL100 No Lead 3/4" NPT x 1" Plastic Pipe Elbow
- ❖RBHTNL75 No Lead 3/4" NPT x 3/4" Plastic Pipe Tee
- ❖RBHTNL7510 No Lead 3/4" NPT x 1" Plastic Pipe Tee

HYDRANTS AVAILABLE WITH OPTIONAL No-Lead Brass Vacuum Breakers

- ASSE-IAPMO Code approved and marked.

- ☆BVBNL75M 3/4" Hose - No Lead Brass Finish - MANUAL DRAIN
- ❖BVBADNL75 3/4" Hose - No Lead Brass - AUTOMATIC DRAIN



BVBADNL75

BVBNL75M

M-2000 Hydrant Flow Rates

WATER SYSTEM PRESSURE	GALLONS PER MINUTE (GPM)										
	0	5	10	15	20	25	30	35	40	45	50
20 PSI	14 GPM @ 20 PSI										
30 PSI	15.5 GPM @ 30 PSI										
40 PSI	16.3 GPM @ 40 PSI										
60 PSI	18.8 GPM @ 60 PSI										
80 PSI	20.3 GPM @ 80 PSI										
100 PSI	22 GPM @ 100 PSI										

NOTE: Ideal conditions for 1/2" NPT submersible pump output is 10 GPM.

E-5000 SERIES

"The Best of Both Worlds-Quality and Price"

FROST PROOF YARD HYDRANT

Features/Benefits

- * (1) **LEVER CONTROL** operates by cam principle and pulls straight up on operating rod. Provides variable flow from trickle to full flow without lock to hold lever.
BENEFIT: Variable flow with no lock that rusts in place.
- (2) **DRAW STRAPS** are made of 1040 hot rolled steel which is much harder (Brinell 175/200) and stronger. Greatly reduces wear of straps and eliminates side pull on operating rod.
BENEFIT: Longest operating life.
- (3) **OPERATING ROD** has smooth galvanized surface for maximum packing life.
BENEFIT: Longer service life of seal around rod.
- (4) **HEAVY-DUTY SOLID HOSE ADAPTER** threaded for standard 3/4" hose coupling.
BENEFIT: Standard hose fitting, readily available.
- (5) **HEAVY CAST IRON HEAD** with the same design Merrill has used for over sixty years.
BENEFIT: Time-proven design takes years of abuse.
- * (6) **PIVOT CONNECTOR** a 1/4" hex head bolt provides simple positive adjustment and eliminates unreliable set screw used by other companies.
BENEFIT: Adjustable for years, not like rusting set screw.
- (7) **TOUGH PACKING GLAND** for easy plunger removal.
BENEFIT: Less time for plunger replacement.
Option: Metal packing gland available in EM-Series.
- (8) **GALVANIZED PIPE** has no exposed threads subject to the weather.
BENEFIT: No exposed steel on pipe to rust.
- (9) **ONE PIECE PLUNGER** uses double seal design to assure positive shut-off even when foreign particles are present. Plunger positively opens drain to prevent freezing, and positively closes even at slow flow rates.
BENEFIT: Economical design that still closes drain hole.
- * (10) **LONG LIFE PLUNGER** is molded with ethylene propylene material that is self-lubricating and will not bond to brass or no lead brass valve body like rubber plunger used by other companies.
BENEFIT: Longest operating life in one piece design.
- (11) **DOUBLE BYPASS VALVE BODY** provides a large volume of water and the time-proven design used for over sixty years.
BENEFIT: High water flow with economical design.
- (12) **LOCKING EYE** on head and lever allows hydrant to be padlocked shut when not in use.
BENEFIT: Protects from waste of water.
- * (13) **SIMPLEST HYDRANT TO SERVICE** no need to dig up hydrant to inspect plunger. Shut off water supply. Remove lever handle, loosen packing gland in head casting and pull up rod with plunger, or simply unscrew head and pull out rod and plunger.
Benefit: Very simple repair, easily done at ground level.

* EXCLUSIVE MERRILL QUALITY FEATURES

NOTE: If hydrant is to be used in a high pressure application, please contact the factory.



Merrill E-5000 Series Yard Hydrant
Gives year 'round water service that drains below frost line when shut off.

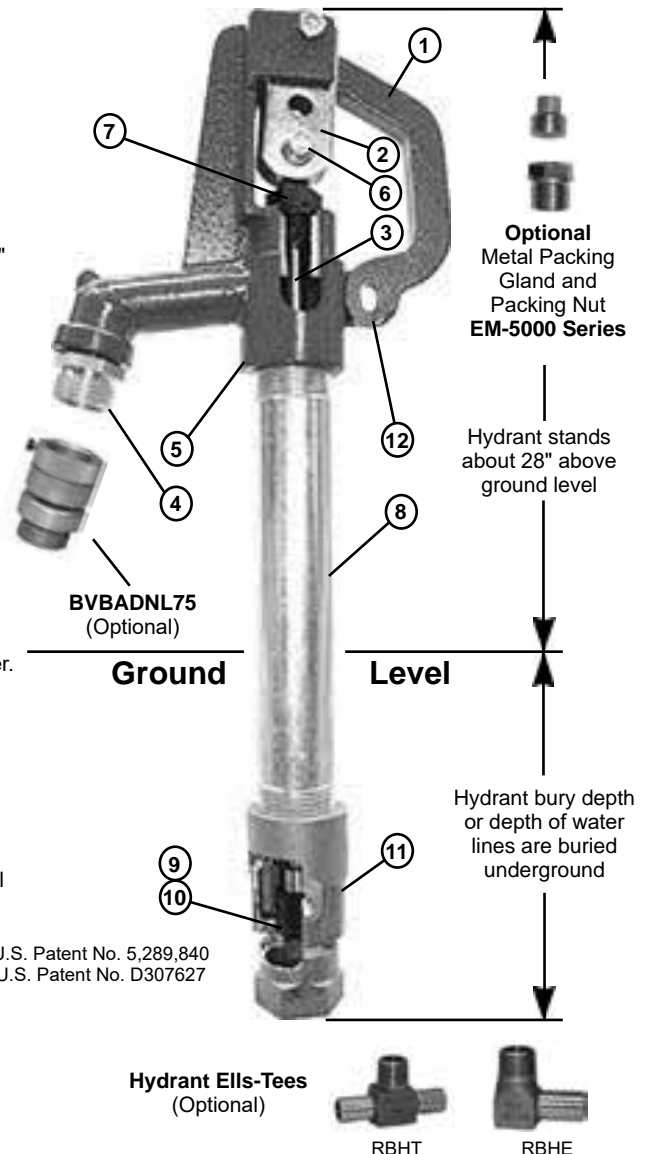

U.S. Patent No. 5,289,840
U.S. Patent No. D307627

Merrill E7504 or 4' Bury Hydrant is about 6'-3-1/2" long, 4' is buried and 28" above ground.

SPECIFICATIONS

E-5000/ENL-5000 Series

Inlet - 3/4" NPT in Casting	Graphite Packing
Outlet - 3/4" Hose Thread Adapter	1" Galvanized Pipe
Brass or No Lead Brass and Molded Rubber Plunger made of self-lubricating material	

☆ No Lead

E-5000/ENL-5000 SERIES & EM-5000/EMNL-5000



E-5000 and
ENL-5000
Series



EM-5000 and
EMNL-5000
Series

E-5000 SERIES HYDRANTS

Order No.	UPC Bar Code (Qty. 1)	Pipe Connection x Pipe Depth	Pipe Size	Overall Length	Approx. Wt./Lbs.
E7501	6 42367 05423 6	3/4" x 1' Bury	1" Galv.	39.5"	9.5
E75015	6 42367 05424 3	3/4" x 1-1/2' Bury	1" Galv.	45.5"	10.5
E7502	6 42367 05425 0	3/4" x 2' Bury	1" Galv.	51.5"	11.5
E7503	6 42367 05426 7	3/4" x 3' Bury	1" Galv.	63.5"	12.5
E7504	6 42367 05427 4	3/4" x 4' Bury	1" Galv.	75.5"	13.5
E7505	6 42367 05428 1	3/4" x 5' Bury	1" Galv.	87.5"	14.5
E7506	6 42367 05429 8	3/4" x 6' Bury	1" Galv.	99.5"	15.5
E7507	6 42367 05430 4	3/4" x 7' Bury	1" Galv.	111.5"	16.5
E7508	6 42367 05431 1	3/4" x 8' Bury	1" Galv.	123.5"	17.5
E7510	6 42367 05432 8	3/4" x 10' Bury	1" Galv.	147.5"	19.5

NOTE: The length of hydrant you need depends on the depth the water lines are buried in your area. If water lines are buried 4' you need the E7504 - 4' bury below ground with 28" above ground or 6'-3-1/2" total length.

ENL-5000 NO LEAD SERIES HYDRANTS

Order No.	UPC Bar Code (Qty. 1)	Pipe Connection x Pipe Depth	Pipe Size	Overall Length	Approx. Wt./Lbs.
☆ENL7501	6 42367 41824 3	3/4" x 1' Bury	1" Galv.	39.5"	9.5
☆ENL7502	6 42367 41825 0	3/4" x 2' Bury	1" Galv.	51.5"	11.5
☆ENL7503	6 42367 41826 7	3/4" x 3' Bury	1" Galv.	63.5"	12.5
☆ENL7504	6 42367 41827 4	3/4" x 4' Bury	1" Galv.	75.5"	13.5
☆ENL7505	6 42367 41828 1	3/4" x 5' Bury	1" Galv.	87.5"	14.5
☆ENL7506	6 42367 41829 8	3/4" x 6' Bury	1" Galv.	99.5"	15.5
☆ENL7507	6 42367 41830 4	3/4" x 7' Bury	1" Galv.	111.5"	16.5
☆ENL7508	6 42367 41831 1	3/4" x 8' Bury	1" Galv.	123.5"	17.5
☆ENL7510	6 42367 41833 5	3/4" x 10' Bury	1" Galv.	147.5"	19.5

NOTE: The length of hydrant you need depends on the depth the water lines are buried in your area. If water lines are buried 4' you need the ENL7504 - 4' bury below ground with 28" above ground or 6'-3-1/2" total length.

EM-5000 SERIES HYDRANTS *

Order No.	UPC Bar Code (Qty. 1)	Pipe Connection x Pipe Depth	Pipe Size	Overall Length	Approx. Wt./Lbs.
EM7501	6 42367 11794 8	3/4" x 1' Bury	1" Galv.	39.5"	9.5
EM75015	6 42367 11795 5	3/4" x 1-1/2' Bury	1" Galv.	45.5"	10.5
EM7502	6 42367 11796 2	3/4" x 2' Bury	1" Galv.	51.5"	11.5
EM7503	6 42367 11797 9	3/4" x 3' Bury	1" Galv.	63.5"	12.5
EM7504	6 42367 11798 6	3/4" x 4' Bury	1" Galv.	75.5"	13.5
EM7505	6 42367 11799 3	3/4" x 5' Bury	1" Galv.	87.5"	14.5
EM7506	6 42367 11800 6	3/4" x 6' Bury	1" Galv.	99.5"	15.5
EM7507	6 42367 11801 3	3/4" x 7' Bury	1" Galv.	111.5"	16.5
EM7508	6 42367 11802 0	3/4" x 8' Bury	1" Galv.	123.5"	17.5
EM7510	6 42367 11803 7	3/4" x 10' Bury	1" Galv.	147.5"	19.5

* with metal packing gland

EMNL-5000 NO LEAD SERIES HYDRANTS *

Order No.	UPC Bar Code (Qty. 1)	Pipe Connection x Pipe Depth	Pipe Size	Overall Length	Approx. Wt./Lbs.
☆EMNL7501	6 42367 41834 2	3/4" x 1' Bury	1" Galv.	39.5"	9.5
☆EMNL75015	6 42367 42774 0	3/4" x 1-1/2' Bury	1" Galv.	45.5"	10.5
☆EMNL7502	6 42367 41835 9	3/4" x 2' Bury	1" Galv.	51.5"	11.5
☆EMNL7503	6 42367 41836 6	3/4" x 3' Bury	1" Galv.	63.5"	12.5
☆EMNL7504	6 42367 41837 3	3/4" x 4' Bury	1" Galv.	75.5"	13.5
☆EMNL7505	6 42367 41838 0	3/4" x 5' Bury	1" Galv.	87.5"	14.5
☆EMNL7506	6 42367 41839 7	3/4" x 6' Bury	1" Galv.	99.5"	15.5
☆EMNL7507	6 42367 41840 3	3/4" x 7' Bury	1" Galv.	111.5"	16.5
☆EMNL7508	6 42367 41841 0	3/4" x 8' Bury	1" Galv.	123.5"	17.5
EMNL7510	6 42367 41842 7	3/4" x 10' Bury	1" Galv.	147.5"	19.5

* with metal packing gland

E-5000 Hydrant Flow Rates

WATER SYSTEM PRESSURE	GALLONS PER MINUTE (GPM)										
	0	5	10	15	20	25	30	35	40	45	50
20 PSI	15.4 GPM @ 20 PSI										
30 PSI	18 GPM @ 30 PSI										
40 PSI	22 GPM @ 40 PSI										
60 PSI	27 GPM @ 60 PSI										
80 PSI	32 GPM @ 80 PSI										
100 PSI	36 GPM @ 100 PSI										

NOTE: Most common 1/2 hp submersible pump output is 10 GPM.

☆ No Lead

❖ CA. Certified

E-5000/ENL-5000 SERIES & EM-5000/EMNLS5000

PARTS LIST

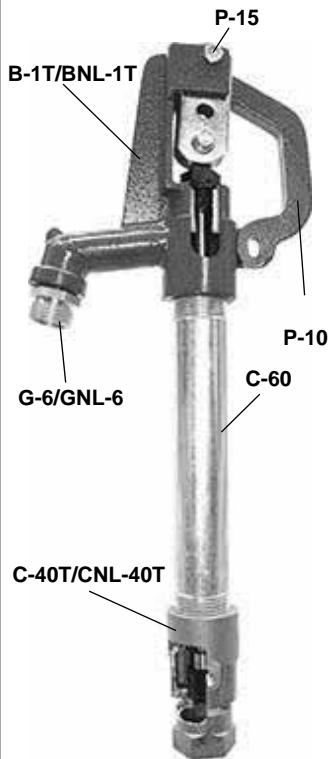

PARTS KIT "E"

Qty.	Part No.
4	C-5
3 Pr.	G-20
2	B-25
3	C-30
3	C-31
3	OR116
3	C-35
3	C-115

ORDER NO. PKE
UPC Bar Code (Qty. 1)
6 42367 06111 1

Hydrants available with optional Red Brass or No Lead Bronze Hydrant Ells/Tees.

Include number (i.e. RBHE75) after Order No.

RBHE75, RBHE100, RBHT75, RBHT7510

No Lead Bronze Hydrant Ells/Tees

RBHENL75, RBHENL100, RBHTNL75, RBHTNL7510

Hydrants available with optional No Lead Vacuum Breakers

• ASSE-IAPMO Code approved and marked.

BVBADNL75 and BVBNL75M

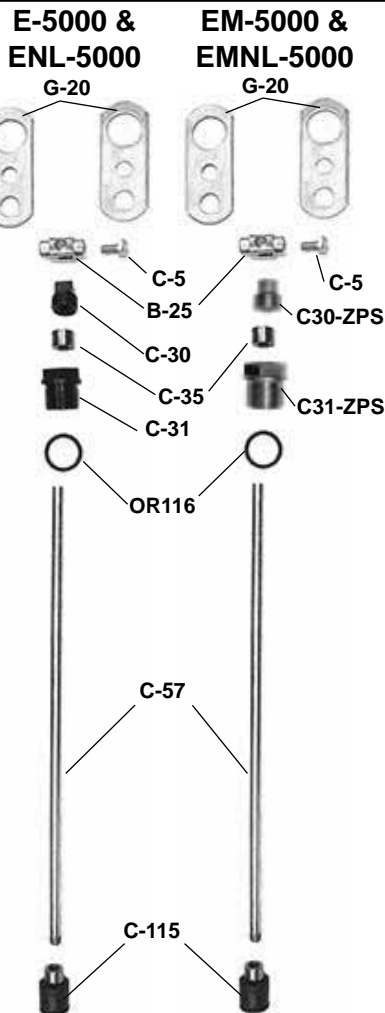

PARTS KIT "EM"

Qty.	Part No.
4	C-5
3 Pr.	G-20
2	B-25
3	C30-ZPS
3	C31-ZPS
3	OR116
3	C-35
3	C-115

ORDER NO. PKEM
UPC Bar Code (Qty. 1)
6 42367 11804 4



PARTS LIST

Part No.	UPC Bar Code (Qty. 1)	Part Description
☆ B-1T	6 42367 05480 9	Head Casting (Includes G-6)
☆ BNL-1T	6 42367 42437 4	No Lead Head Casting (Includes GNL-6)
☆ C-5	6 42367 03308 8	Stainless Steel 1/4" Hex Head Bolt
G-6	6 42367 01543 5	Hose Thread Adapter
☆ GNL-6	6 42367 41048 3	No Lead Hose Thread Adapter
☆ P-10	6 42367 01979 2	Lever Casting
☆ P-15	6 42367 01985 3	Lever Bolt & Nut
☆ G-20	6 42367 01514 5	Draw Straps (Per Pr.)
☆ B-25	6 42367 57695 2	Pivot Connector
☆ C-30	6 42367 05369 7	Packing Nut
☆ C-31	6 42367 05370 3	Packing Gland
☆ C30-ZPS	6 42367 11741 2	Metal Packing Nut
☆ C31-ZPS	6 42367 11740 5	Metal Packing Gland
☆ C-35	6 42367 05476 2	Valve Stem Packing
☆ OR116	6 42367 05481 6	O-Ring Seal
C-40T	6 42367 10044 5	Valve Body
❖ CNL-40T	6 42367 41695 9	No Lead Valve Body
☆ C-57		5/16" Operating Rod
☆ C-60		1" Galvanized Pipe
☆ C-115	6 42367 00974 8	Plunger
B-121	6 42367 05484 7	Head Assembly Parts No.
		B-1T, B-25, C-5, C-30, C-31, C-35, G-6, G-20, OR116, P-10 & P-15
☆ BNL-121	6 42367 42438 1	No Lead Head Assembly Parts No.
		BNL-1T, B-25, C-5, C-30, C-31, C-35, GNL-6, G-20, OR116, P-10 & P-15
BM-121	6 42367 42360 5	Head Assembly Parts No.
		B-1T, B-25, C-5, C30-ZPS, C31-ZPS, C-35, G-6, G-20, OR116, P-10 & P-15
☆ BMNL-121	6 42367 42439 8	No Lead Head Assembly Parts No.
		BNL-1T, B-25, C-5, C30-ZPS, C31-ZPS, C-35, GNL-6, G-20, OR116, P-10 & P-15
☆ C-131	6 42367 09912 1	Packing Gland Assembly
		C-30, C-31, C-35, OR116
☆ C131-ZPS	6 42367 11777 1	Packing Gland Assembly
		C30-ZPS, C31-ZPS, C-35, OR116
☆ A-250	6 42367 07720 4	Container of Silicone Lube

PARTS KIT "EF"

Qty.	Part No.
1	C-5
1 Pr.	G-20
1	B-25
1	C-30
1	C-31
1	OR116
1	C-35
1	C-115

ORDER NO. PKEF
UPC Bar Code (Qty. 1)
6 42367 05793 0

PARTS KIT "EFM"

Qty.	Part No.
1	C-5
1 Pr.	G-20
1	B-25
1	C30-ZPS
1	C31-ZPS
1	OR116
1	C-35
1	C-115

ORDER NO. PKEFM
UPC Bar Code (Qty. 1)
6 42367 11805 1

PARTS KIT "EP"

Qty.	Part No.
1	C-35
1	C-115
1	A-250

ORDER NO. PKEP
UPC Bar Code (Qty. 1)
6 42367 07721 1



B-7000 & BNL-7000 SERIES

FROST PROOF YARD HYDRANT FEATURES/BENEFITS

- (1) **HEAVY CAST IRON HEAD** simple "on" flow design
BENEFIT: Stands up to abuse, "on" design has higher flow.
- (2) **ONE LIFTING STRAP** simple ribbed design
BENEFIT: Ribbed design greatly increases strength and centered single strap eliminates side pull.
- (3) **HEAVY CAST IRON HANDLE** simple oversized design
BENEFIT: Very easy to operate, extra room for big hands.
- (4) **NO ADJUSTMENT NEEDED** patented design eliminates need for adjustment (CAUTION: do not push clamp on pipe down - will damage plunger.)
BENEFIT: Design of plunger and valve body automatically adjusts itself - no field guess work.
- (5) **NO PACKING GLAND REQUIRED** simple fool proof design
BENEFIT: No packing or packing gland to service - on site field work very simple.
- (6) **EASY PLUNGER SEAL REPLACEMENT** only loosen one bolt.
BENEFIT: O-ring seals very easy to replace when lift out plunger.
- (7) **1" GALVANIZED RISER PIPE WITH PVC INNER PIPE**
BENEFIT: Sch. 80 PVC inner pipe strong - non-corrosive.
- (8) **1" VALVE INLET SIZE**
BENEFIT: Easy installation and better flow rate.
- (9) **DOUBLE BYPASS VALVE BODY** provides a large volume of water and time-proven design for over 60 years.
BENEFIT: High water flow with economical patented design.
- (10) **HYDRANT LOCKING EYE**
- (11) **LEVER STRAP BOLT**
- (12) **ONE PIECE PLUNGER**
- (13) **HOSE THREAD FITTING**
- (14) **LEVER PIVOT BOLT**
- (15) **LEVER STRAP PIVOT CONTROL**

NOTE: This model of hydrant requires more time to drain itself. If you turn the hydrant back on when it is still draining, water will come out outlet **AND** drain hole. Hydrant is working normally.

Merrill B-7000 and BNL-7000 Series Frost Proof Yard Hydrant

Gives year 'round water service that drains below the frost line when shut off.

Patent No. US 8,408,238

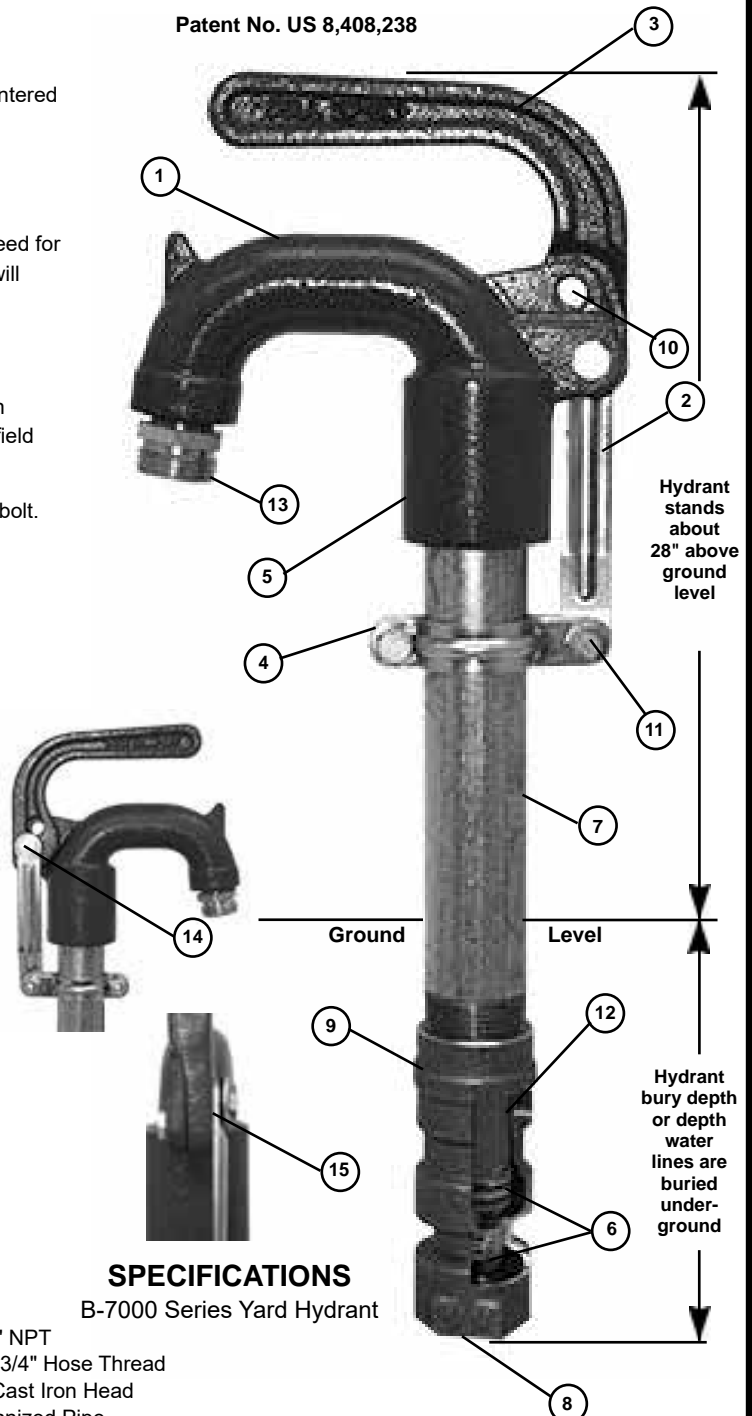

SPECIFICATIONS

B-7000 Series Yard Hydrant

Inlet - 1" NPT
 Outlet - 3/4" Hose Thread
 Heavy Cast Iron Head
 1" Galvanized Pipe
 Heavy Cast Brass or No Lead Brass Valve Body
 with two flow ways Patented Double Cyclinder Valve Body

☆ No Lead

B-7000 & BNL-7000 SERIES

PARTS LIST

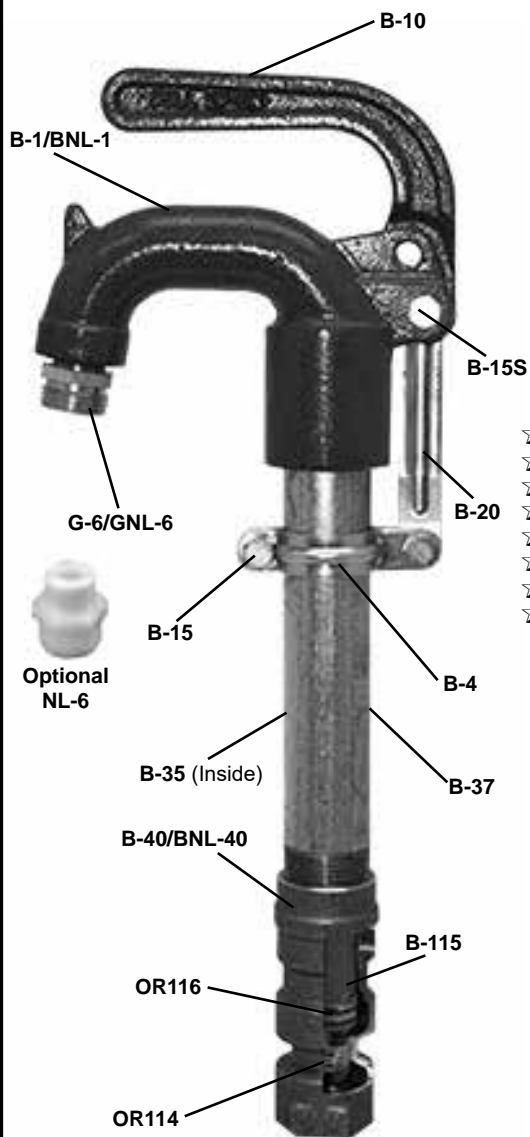

B-7000 & BNL-7000 Hydrant Flow Rate

WATER SYSTEM PRESSURE	GALLONS PER MINUTE (GPM)
	0 5 10 15 20 25 30 35 40 45 50
10 PSI	4 GPM @ 10 PSI
20 PSI	10 GPM @ 20 PSI
30 PSI	12 GPM @ 30 PSI
40 PSI	15 GPM @ 40 PSI
60 PSI	20 GPM @ 60 PSI
80 PSI	22 GPM @ 80 PSI
100 PSI	26 GPM @ 100 PSI

NOTE: Most common 1/2 hp submersible pumps output is 10GPM.

FROST PROOF YARD HYDRANTS STANDARD B-7000 SERIES HYDRANTS

Order No.	UPC Bar Code (Qty. 1)	Pipe Connection x Pipe Depth	Pipe Size	Overall Length	Approx. Wt./Lbs.
B101	6 42367 41329 3	1" x 1' Bury	1" Galv.	39.5"	11.0
B102	6 42367 41330 9	1" x 2' Bury	1" Galv.	51.5"	13.0
B103	6 42367 41328 6	1" x 3' Bury	1" Galv.	63.5"	15.3
B104	6 42367 41331 6	1" x 4' Bury	1" Galv.	75.5"	17.0
B105	6 42367 41332 3	1" x 5' Bury	1" Galv.	87.5"	19.0
B106	6 42367 41333 0	1" x 6' Bury	1" Galv.	99.5"	21.0
B107	6 42367 41334 7	1" x 7' Bury	1" Galv.	111.5"	23.0
B108	6 42367 41335 4	1" x 8' Bury	1" Galv.	123.5"	25.0

NOTE: The length of hydrant you need depends on the depth the water lines are buried in your area. If water lines are buried 4' you need the B104 - 4' bury below ground 28" above ground or 6'-4" total length.

FROST PROOF YARD HYDRANTS NO LEAD BNL-7000 SERIES HYDRANTS

Order No.	UPC Bar Code (Qty. 1)	Pipe Connection x Pipe Depth	Pipe Size	Overall Length	Approx. Wt./Lbs.
☆ BNL101	6 42367 42347 6	1" x 1' Bury	1" Galv.	39.5"	11.0
☆ BNL102	6 42367 42348 3	1" x 2' Bury	1" Galv.	51.5"	13.0
☆ BNL103	6 42367 42349 0	1" x 3' Bury	1" Galv.	63.5"	15.3
☆ BNL104	6 42367 42350 6	1" x 4' Bury	1" Galv.	75.5"	17.0
☆ BNL105	6 42367 42351 3	1" x 5' Bury	1" Galv.	87.5"	19.0
☆ BNL106	6 42367 42352 0	1" x 6' Bury	1" Galv.	99.5"	21.0
☆ BNL107	6 42367 42353 7	1" x 7' Bury	1" Galv.	111.5"	23.0
☆ BNL108	6 42367 42354 4	1" x 8' Bury	1" Galv.	123.5"	25.0

NOTE: The length of hydrant you need depends on the depth the water lines are buried in your area. If water lines are buried 4' you need the BNL104 - 4' bury below ground 28" above ground or 6'-4" total length.

PARTS LIST

Part No.	UPC Bar Code (Qty. 1)	Part Description
B-1	6 42367 41576 1	B-7000 Head Casting (Includes G-6)
☆ BNL-1	6 42367 42440 4	B-7000 No Lead Head Casting (Includes GNL-6)
G-6	6 42367 11756 6	Hose Thread Adapter
☆ NL-6	6 42367 10876 2	Nylon Hose Thread Adapter
☆ GNL-6	6 42367 41048 3	No Lead Hose Thread Adapter
☆ B-10	6 42367 41577 8	Lever Casting
☆ B-15S	6 42367 41578 5	Lever Bolt
☆ B-15	6 42367 41579 2	Clamp Bolts
☆ B-4	6 42367 41580 8	Pipe Clamp
☆ B-20	6 42367 41581 5	Lifting Strap
☆ G-15A	6 42367 41582 2	Nuts for Clamp Bolt
☆ B-16	6 42367 41583 9	Lever Pivot Control
☆ B-50	6 42367 41584 6	Plunger Coupling
☆ B-115	6 42367 41585 7	Plunger
☆ OR114	6 42367 00113 1	Bottom Plunger O-Rings (Std. Size 114)
☆ OR116	6 42367 05481 6	Top Plunger O-Rings (Std. Size 116)
B-40	6 42367 41586 0	Valve Body
☆ BNL-40	6 42367 42408 4	No Lead Valve Body
☆ B-37		1" Galvanized Pipe
☆ B-35		PVC Riser



ORDER NO. PKBF
UPC Bar Code (Qty. 1)
6 42367 41598 3

PARTS KIT "BF" CONTAINS

Qty.	Part Number
1	B-20 Lifting Strap
1	B-15S Lever Bolt
2	B-15 Clamp Bolts
2	G-15A Nuts for Clamp Bolt
2	OR114 Bottom Plunger O-Rings
2	OR116 Top Plunger O-Rings

☆ No Lead

❖ CA. Certified

YARD HYDRANT ACCESSORIES

Red Brass Hydrant Ells and Tees

- Reduced number of fittings
- Flat sides for wrench
- Flat bottom for better installation
- Will not break by ground settling like plastic fittings

Order No.	UPC Bar Code (Qty. 1)	Insert Size x MIP Size	Ctn. Qty.	Approx. Wt./Lbs.
RBHE75	6 42367 02374 4	3/4" x 3/4"	10	0.42
RBHE100	6 42367 02372 0	1" x 3/4"	10	0.52
RBHEL100	6 42367 05394 9	1" x 3/4"	10	0.61
RBHE1025	6 42367 10030 8	1-1/4" x 1"	5	0.90
RBHE1000	6 42367 02373 7	1" x 1"	10	0.58
RBHEL1000	6 42367 04463 3	1" x 1"	10	0.62
RBHE125	6 42367 04783 2	1-1/4" x 1-1/4"	5	0.86
RBHT75	6 42367 02376 8	3/4" x 3/4"	10	0.48
RBHT7510	6 42367 02377 5	1" x 3/4"	10	0.63
RBHT1000	6 42367 02375 1	1" x 1"	10	0.72



Hose Bibb Adapters

Order No.	UPC Bar Code (Qty. 1)	Description
HBA750	6 42367 01682 1	3/4" male hose x 3/4" female hose
• Optional for M-2000 Series Yard Hydrants.		
HBA500 or G-6	6 42367 01543 5	3/4" hose x 1/2" NPT
• Replacement hose bibb adapter for Any Flow, Self Closing and C-1000 Series Yard Hydrants.		
G-7	6 42367 10992 9	3/4" hose x 3/4" NPT
☆ GNL-7	6 42367 41985 1	No Lead Brass 3/4" hose x 3/4" NPT
☆ NL-6	6 42367 10876 2	Nylon 3/4" hose x 1/2" NPT
☆ GNL-6	6 42367 41048 3	No Lead Brass 3/4" hose x 1/2" NPT



No Lead Vacuum Breakers

- ASSE and IAPMO Code Approved and Marked

Order No.	UPC Bar Code (Qty. 1)	Description	Ctn. Qty.	Approx. Wt./Lbs.
☆ BVBADNL75	6 42367 12470 0	3/4" hose thread - brass finish AUTOMATIC DRAIN - No Lead	6	0.33
☆ BVBNL75M	6 42367 41957 8	3/4" hose thread - brass finish MANUAL DRAIN - No Lead	10	0.22



Merrill Universal Yard Hydrant - Parts Kit "U"

Part No.	Description	Hydrant Part Used In	Qty.
G-6	Hose Adapter	Any Flow, C-1000	2
G-20	Draw Straps	Any Flow, C-1000, M-2000	3 pr.
G-25	Pivot Connector & Nuts	Any Flow, C-1000, M-2000	2
G-30	Packing Nut	Any Flow, C-1000, M-2000	3
G-45	Stainless Steel Rod	Any Flow, C-1000, M-2000	2
G-50	Brass Reducer (3/8" - 7/16")	Any Flow	2
P-50	Steel Connector (3/8" - 3/8")	C-1000, M-2000	2
G-85	3/8" Leather Beveled Bibb Washer	Any Flow	3
G-105	Cup Leathers	Any Flow	3 pr.
G-115	Plunger Assembly	Any Flow	2
A-115	Plunger	C-1000	2
P-115	Plunger	M-2000	2

Order No.	UPC Bar Code (Qty.1)	Weight
UPK	6 42367 02834 3	3.0 lbs.



UPK

Any Temp®/ H-3000

HEATED YARD HYDRANT FEATURES/BENEFITS

The Any Temp®/ H-3000 Series Water Riser/Heated Hydrant gives year 'round water service with use of self-regulating heat cable or by draining itself below frost line when shut off.

The Heated Hydrant is a simple unit designed to provide frost proof water service. It completes the sanitary installation from buried water line to above ground water connection, or supply pipe with shut-off valve, needed for each mobile or manufactured home.

- * (1) **LOCKS OPEN OR CLOSED** Simply turn clockwise to lock hydrant open or closed and set screw lock provided so hydrant can not be adjusted without a hex wrench.
BENEFIT: Prevent vandalism or accidental shut off of water.
- (2) **OUTLET OF HYDRANT** 3/4" pipe thread molded into Zytel® Super Tough by DuPont, one of the world's toughest thermoplastic.
BENEFIT: Standard pipe size for connection and will not corrode.
- (3) **WATER FLOW** thru plunger and galvanized pipe or 3/4" rigid copper.
BENEFIT: Provides high flow rate needed without increasing cost.
- * (4) **PLUNGER** has (4) Ethylene Propylene quad ring seals which never come out of adjustment, have longer life than O-rings and withstand higher pressures.
BENEFIT: Longest operating life ring seals.
- (5) **HEAVY MOLDED DELRIN® VALVE BODY** Delrin® has been used in valves for over forty years and is molded to close tolerance.
BENEFIT: Will not corrode or rust out.
- * (6) **EXTRA HEAVY STEEL COLLAR** at ground level to protect hydrant from normal abuse when mowing grass or shoveling snow.
BENEFIT: Hydrant will stand up to years of abuse.
- (7) **SWIVEL PARTS** permit withdrawal of all moving parts without digging up hydrant. A 3/16" hex key will allow disassembly of hydrant by simply removing the two cap screws and pull up riser pipe with plunger for inspection.
BENEFIT: Very simple repair and taken apart with one tool.
- * (8) **ENERGY EFFICIENT HEATING CABLE** A high technology self-regulating cable that provides only the amount of heat needed for the varying outdoor temperature and does not waste electricity like the heat rod used by another company. The heating cable has as long a life as any other on the market today.
BENEFIT: Longest life and very low cost of operation.
- * (9) **HEATING CABLE BUILT INTO HYDRANT** Can not be stolen like heat rod used by another company, and no electrical hazard since heating cable is not immersed in water flow thru hydrant.
BENEFIT: Longest service life and no electrical hazard.

*EXCLUSIVE MERRILL QUALITY FEATURES



Any Temp®/ H-3000 Series Water Riser/Heated Hydrant

Gives year 'round water service that drains below the frost line when shut off.

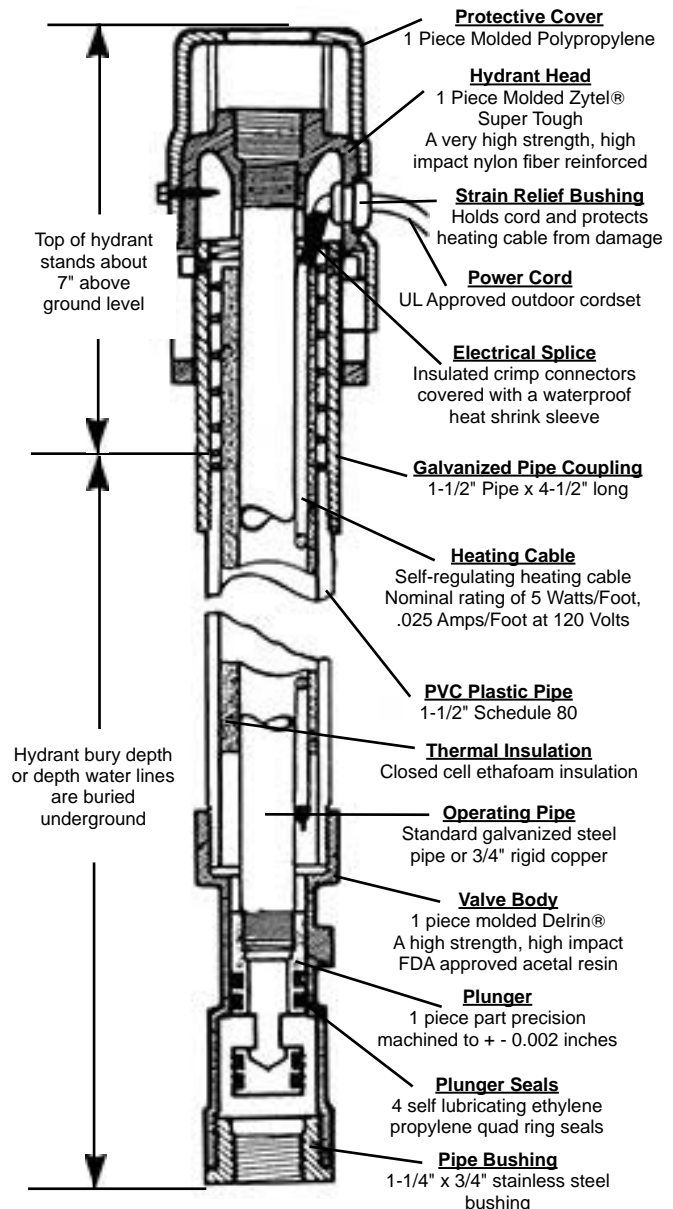

Recommended Maximum Operating
Pressure 60 psi

Any Temp®/ H-3000 ☆ No Lead

Specifications

Specify as follows:

Water Connectors shall be Merrill *Any Temp*®
Heated Hydrant _____ ft. bury with
5 watts/ft. self-regulating heating cable,
Ethafoam insulation, simple sanitary
straight line design.

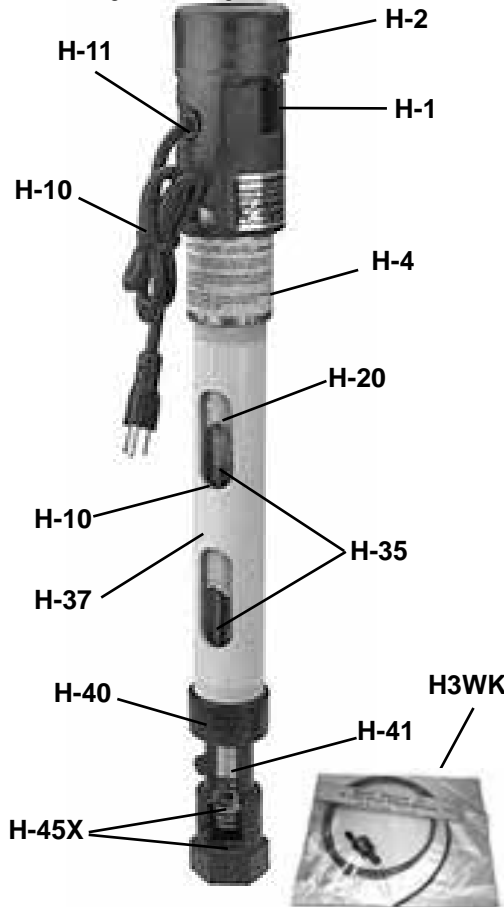

Any Temp®/ H-3000 Series Parts List

Order No.	UPC Bar Code (Qty. 1)	Part Description
H-1	6 42367 01606 7	Head Complete
H-2	6 42367 01621 0	Head Cover
H-4	6 42367 01641 8	Steel Collar
H-5	6 42367 01655 5	5/16" Socket Head Cap Screw
H-6	6 42367 01656 2	1/2" Self-Tapping Screw
Y-8	6 42367 03100 8	3/8" x 5/16" Socket Head Cap Screw
H-10		Heating Cable with Cord Set
H-11	6 42367 01618 0	Strain Relief Bushing
H-20	6 42367 06036 7	Ethafoam Insulation
H-35		Galvanized Pipe - Copper Tube
H-37		1-1/2" Sch. 80 PVC Pipe
SSHB12575	6 42367 12174 7	S.S. Hex Bushing
H-40	6 42367 01642 5	Valve Body
H-40D	6 42367 01644 9	Valve Body with Drain Hole
H-41	6 42367 01651 7	Plunger Assembly with 4 Quad Ring Seals
H-45X	6 42367 01653 1	Quad Ring Seals
A-250	6 42367 07720 4	Container of Silicone Lube
H3WK	6 42367 03431 3	Winterize Kit (for models with no drain holes)

Any Temp®/ H-3000 Series with Drain Back

Order No.	UPC Bar Code (Qty. 1)	Inlet Size x Length	Riser Pipe	Overall Length	Approx. Wt./Lbs.
Standard					
☆H7501D	6 42367 01658 6	3/4" x 1' Bury	1/2" Galv. Pipe	18"	4.2
☆H7502D	6 42367 01661 6	3/4" x 2' Bury	1/2" Galv. Pipe	30"	5.7
☆H7503D	6 42367 01664 7	3/4" x 3' Bury	1/2" Galv. Pipe	42"	7.2
☆H7504D	6 42367 01667 8	3/4" x 4' Bury	1/2" Galv. Pipe	54"	8.8
☆H7505D	6 42367 01670 8	3/4" x 5' Bury	1/2" Galv. Pipe	66"	10.4
☆H7506D	6 42367 01673 9	3/4" x 6' Bury	1/2" Galv. Pipe	78"	12.0
☆H7507D	6 42367 01675 3	3/4" x 7' Bury	1/2" Galv. Pipe	90"	13.6
☆H7508D	6 42367 01677 7	3/4" x 8' Bury	1/2" Galv. Pipe	102"	15.2
☆H7510D	6 42367 01679 1	3/4" x 10' Bury	1/2" Galv. Pipe	126"	18.4

Deluxe

☆DH7501D	6 42367 01118 5	3/4" x 1' Bury	3/4" Copper	18"	4.0
☆DH7502D	6 42367 01120 8	3/4" x 2' Bury	3/4" Copper	30"	5.5
☆DH7503D	6 42367 01122 2	3/4" x 3' Bury	3/4" Copper	42"	7.0
☆DH7504D	6 42367 01124 6	3/4" x 4' Bury	3/4" Copper	54"	8.6
☆DH7505D	6 42367 01126 0	3/4" x 5' Bury	3/4" Copper	66"	10.2
☆DH7506D	6 42367 01128 4	3/4" x 6' Bury	3/4" Copper	78"	11.8
☆DH7507D	6 42367 01130 7	3/4" x 7' Bury	3/4" Copper	90"	13.4
☆DH7508D	6 42367 01132 1	3/4" x 8' Bury	3/4" Copper	102"	15.0
☆DH7510D	6 42367 01134 5	3/4" x 10' Bury	3/4" Copper	126"	18.2

Heating Cable included. Insulation only (No Heating Cable) add "NC" after Order No.

Any Temp®/ H-3000 Series for Municipal Water Systems

Order No.	UPC Bar Code (Qty. 1)	Inlet Size x Length	Pipe Size	Overall Length	Approx. Wt./Lbs.
Standard					
☆H7501	6 42367 01657 9	3/4" x 1' Bury	1/2" Galv. Pipe	18"	4.2
☆H7502	6 42367 01659 3	3/4" x 2' Bury	1/2" Galv. Pipe	30"	5.7
☆H7503	6 42367 01662 3	3/4" x 3' Bury	1/2" Galv. Pipe	42"	7.2
☆H7504	6 42367 01665 4	3/4" x 4' Bury	1/2" Galv. Pipe	54"	8.8
☆H7505	6 42367 01668 5	3/4" x 5' Bury	1/2" Galv. Pipe	66"	10.4
☆H7506	6 42367 01671 5	3/4" x 6' Bury	1/2" Galv. Pipe	78"	12.0
☆H7507	6 42367 01674 6	3/4" x 7' Bury	1/2" Galv. Pipe	90"	13.6
☆H7508	6 42367 01676 0	3/4" x 8' Bury	1/2" Galv. Pipe	102"	15.2
☆H7510	6 42367 01678 4	3/4" x 10' Bury	1/2" Galv. Pipe	126"	18.4

Deluxe

☆DH7501	6 42367 01117 8	3/4" x 1' Bury	3/4" Copper	18"	4.0
☆DH7502	6 42367 01119 2	3/4" x 2' Bury	3/4" Copper	30"	5.5
☆DH7503	6 42367 01121 5	3/4" x 3' Bury	3/4" Copper	42"	7.0
☆DH7504	6 42367 01123 9	3/4" x 4' Bury	3/4" Copper	54"	8.6
☆DH7505	6 42367 01125 3	3/4" x 5' Bury	3/4" Copper	66"	10.2
☆DH7506	6 42367 01127 7	3/4" x 6' Bury	3/4" Copper	78"	11.8
☆DH7507	6 42367 01129 1	3/4" x 7' Bury	3/4" Copper	90"	13.4
☆DH7508	6 42367 01131 4	3/4" x 8' Bury	3/4" Copper	102"	15.0
☆DH7510	6 42367 01133 8	3/4" x 10' Bury	3/4" Copper	126"	18.2

With Heating Cable - No Drain Back. Insulation only (No Heating Cable) add "NC" after Order Number. **NOTE:** If unit is shut off and unplugged - Winterize Kit needed.

Any Temp® Flow Rates

WATER SYSTEM PRESSURE	GALLONS PER MINUTE (GPM)							
	0	10	20	30	40	50	60	70
20 PSI	30 GPM @ 20 PSI							
30 PSI	36.5 GPM @ 30 PSI							
40 PSI	43.5 GPM @ 40 PSI							
60 PSI	61 GPM @ 60 PSI							

SUMMER AND WINTER WATER LINES

For Mobile / Manufactured Homes

Insulated only for warm climate or heated and insulated for cold climate.

Merrill's Water Line provides THE ANSWER for the outdoor water connection from water riser or heated hydrant. The Water Line is a complete factory assembled package with all the parts needed for a simple installation of the main water supply to the Mobile/Manufactured home.

Water Line Package contains:

- 3/4" Flexible Plastic Pipe
- 3/4" Pipe Thread to Plastic Pipe Fittings
- Stainless Steel Pipe Clamp
- 1/2" Thick Foam Insulation
- Energy Efficient Heating Cable with UL Approved Outdoor Electrical Cord

All factory assembled for easy end connection.

*Ideal for Installation with Merrill *Any Temp*®/H-3000

Series Heated Hydrants

A Frost Proof Riser Pipe and Shut-Off Valve for Connection to Buried Water Line.

Heated Water Line with Swivel*

Order No.	UPC Bar Code (Qty. 1)	Pipe Size	Pipe Length	Approx. Wt./Lbs.
HWLS6	6 42367 01702 6	3/4"	6'	2.6
HWLS8	6 42367 01703 3	3/4"	8'	2.8
HWLS10	6 42367 01697 5	3/4"	10'	3.0
HWLS12	6 42367 01698 2	3/4"	12'	3.2
HWLS15	6 42367 01699 9	3/4"	15'	3.7
HWLS20	6 42367 01700 2	3/4"	20'	4.2
HWLS25	6 42367 01701 9	3/4"	25'	4.7

With 1/2" thick insulation and self-regulating heating cable.

Standard Heated Water Line

Order No.	UPC Bar Code (Qty. 1)	Pipe Size	Pipe Length	Approx. Wt./Lbs.
HWL6	6 42367 01693 7	3/4"	6'	2.3
HWL8	6 42367 01694 4	3/4"	8'	2.5
HWL10	6 42367 01688 3	3/4"	10'	2.7
HWL12	6 42367 01689 0	3/4"	12'	2.9
HWL15	6 42367 01690 6	3/4"	15'	3.2
HWL20	6 42367 01691 3	3/4"	20'	3.7
HWL25	6 42367 01692 0	3/4"	25'	4.2

With 1/2" thick insulation and self-regulating heating cable. Lengths other than listed available - Call for quote.

Insulated Water Line with Swivel*

Order No.	UPC Bar Code (Qty. 1)	Pipe Size	Pipe Length	Approx. Wt./Lbs.
IWLS6	6 42367 01767 5	3/4"	6'	2.3
IWLS8	6 42367 01768 2	3/4"	8'	2.5
IWLS10	6 42367 01762 0	3/4"	10'	2.7
IWLS12	6 42367 01763 7	3/4"	12'	2.9
IWLS15	6 42367 01764 4	3/4"	15'	3.2
IWLS20	6 42367 01765 1	3/4"	20'	3.7
IWLS25	6 42367 01766 8	3/4"	25'	4.2

With 1/2" thick insulation - no heating cable. Lengths other than listed available - Call for quote.

Standard Insulated Water Line

Order No.	UPC Bar Code (Qty. 1)	Pipe Size	Pipe Length	Approx. Wt./Lbs.
IWL6	6 42367 01760 6	3/4"	6'	2.0
IWL8	6 42367 01761 3	3/4"	8'	2.2
IWL10	6 42367 01755 2	3/4"	10'	2.4
IWL12	6 42367 01756 9	3/4"	12'	2.6
IWL15	6 42367 01757 6	3/4"	15'	2.9
IWL20	6 42367 01758 3	3/4"	20'	3.4
IWL25	6 42367 01759 0	3/4"	25'	3.9

With 1/2" thick insulation - no heating cable. Lengths other than listed available - Call for quote.

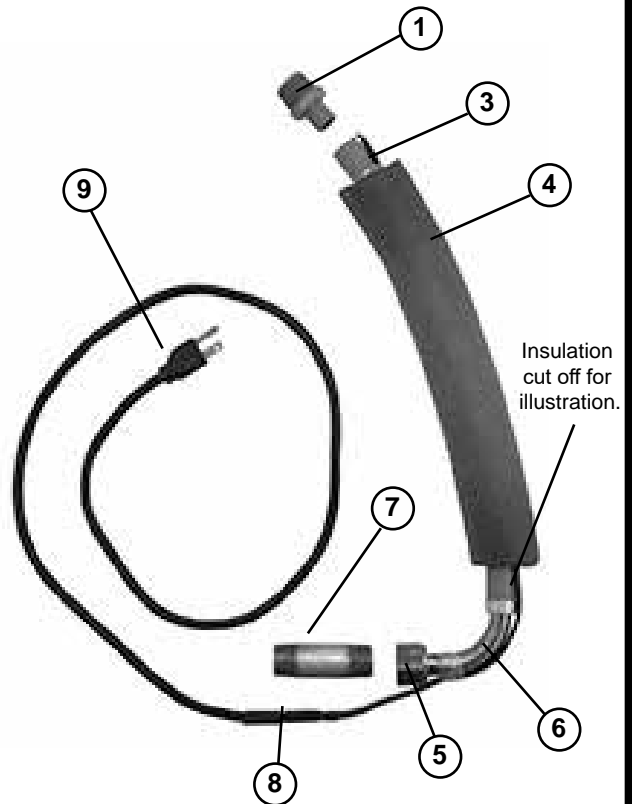

- 1) **Fitting** - 3/4" NPT pipe to 3/4" polyethylene acetal plastic insert fitting
- 2) **Clamp** - All stainless steel with 1/4" slotted hex head screw
- 3) **Plastic Pipe** - Flexible polyethylene pipe 3/4" - 160 PSI rated, approved by all plumbing codes (UPC, IAPMO, NSF, CSA, etc.)
- 4) **Pipe Insulation** - Flexible closed cell polyethylene foam 1/2" thick (Shown cut for illustration purposes).
- 5) **Heating Cable** - Self-regulating heating cable, nominal rating 5 watts/ft. at 120 volts
- 6) **Swivel Elbow** - 3/4" copper tube clamped on to poly pipe and brass nut for swivel
- 7) **Pipe Nipple** - 3/4" pipe x 3" long for connection to water supply and swivel elbow
- 8) **Electrical Splice** - Insulated crimp connectors covered with a waterproof heat shrink sleeve
- 9) **Power Cord** - UL approved outdoor cord 3 ft. long

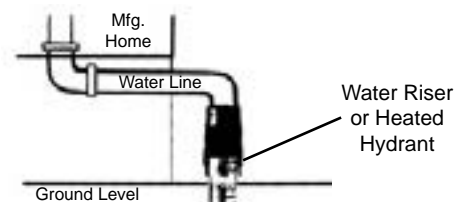

Y-1 SELF CLOSING

FROST PROOF YARD HYDRANT FEATURES/BENEFITS

Several important improvements have been made on the self-closing hydrant over the years. These improvements and the basic design are why we believe the self-closing is the best hydrant of its type in the industry.

- * (1) **SELF-CLOSING** Stainless steel spring and water pressure closes hydrant.
BENEFIT: Hydrant shuts off so water is not wasted. Ideal for public use.
- (2) **LOCKS OPEN OR CLOSED** Simply push lock button to lock hydrant open or closed. (Available WITHOUT locking pin - so only open when the hydrant head is manually pushed down.)
BENEFIT: Hydrant can be locked to restrict use if needed.
- (3) **BRASS OR NO LEAD BRASS HOSE ADAPTER** Heavy-duty hose adapter for standard 3/4" hose coupling.
BENEFIT: Standard garden hose thread in long life non-corrosive brass or no lead brass.
- (4) **EXTRA THICK WALLED HEAD CASTING** greatly reduces breakage and insures longer life.
BENEFIT: Withstands years of use and rough service.
- * (5) **FLOW CONTROL VALVE AVAILABLE** Standard hydrant sold without flow control valve, if wanted order separately. To install simply remove top plug.
BENEFIT: Flow rate can be regulated easily.
- (6) **CAP SCREWS** Hydrants manufactured after 11/1/77 will have 3/8" x 5/16" self-locking socket head cap screws, and assembled with a locking sealant.
BENEFIT: Provides strong hold for hydrant head to pipe for years of service.
- (7) **HIGH QUALITY GALVANIZED PIPE** 1" extra heavy pipe on outside and galvanized pipe on inside.
BENEFIT: Corrosion protected for long life.
- (8) **NO EXPOSED THREADS** on inside pipe or outside pipe.
BENEFIT: No uncoated metal to rust for longest life.
- * (9) **CAST IRON BODY WITH POLISHED BRASS SLEEVE** for plunger seals to travel in, and pressed into heavy cast iron valve body for strength and economy.
BENEFIT: Economical smoother sealing surface for plunger seals.
- * (10) **SOLID BRASS PLUNGER** Hydrants manufactured after 11/1/78 will have (3) ethylene propylene quad ring seals, self-lubricating and never come out of adjustment, have longer life, and withstand higher pressures.
BENEFIT: Longest operating life plunger of its type.
- * (11) **SWIVEL PARTS** permit withdrawal of all moving parts without digging up hydrant. A 3/16" Hex Key will allow disassembly of hydrant by simply removing two cap screws and pull up inside pipe with plunger for inspection.
BENEFIT: Very easy to repair, simple reliable design.

*EXCLUSIVE MERRILL QUALITY FEATURES

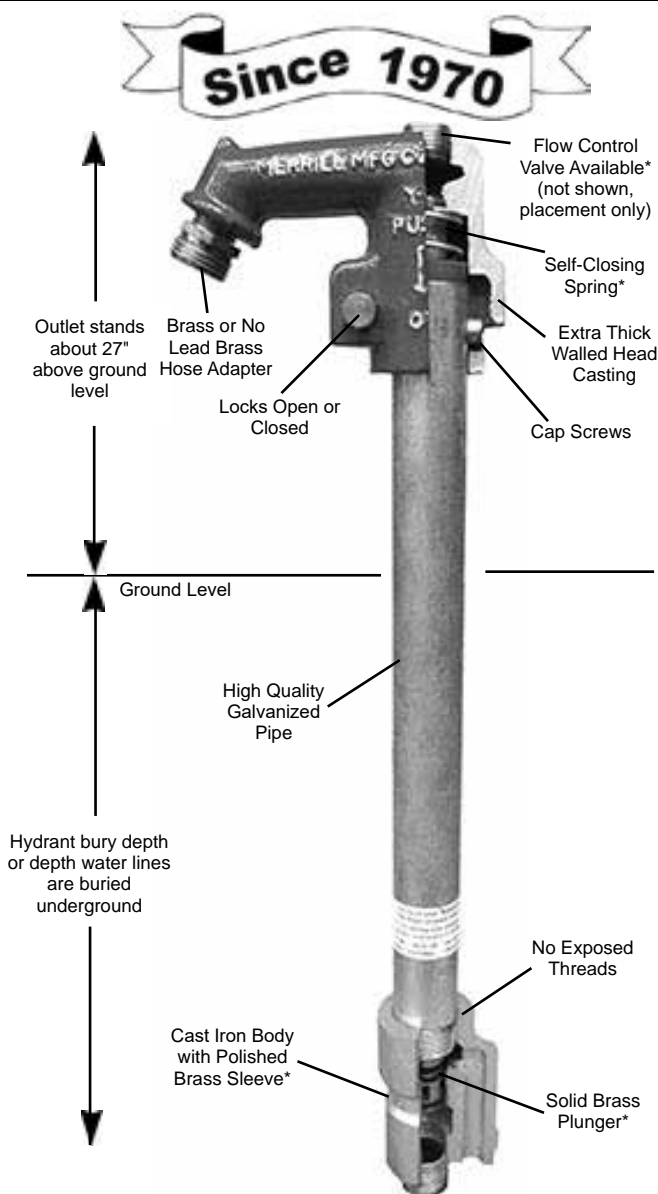

Y-1 FLOW RATES

WATER SYSTEM PRESSURE	STD. 3/4" GALLONS PER MINUTE (GPM)										
	0	5	10	15	20	25	30	35	40	45	50
20 PSI	13.6 GPM @ 20 PSI										
30 PSI	15.2 GPM @ 30 PSI										
40 PSI	18.8 GPM @ 40 PSI										
60 PSI	23 GPM @ 60 PSI										

Recommended Maximum Operating Pressure 60 psi
(Due to Self-Closing Design)
Most common submersible pump 1/2 hp, output 10 GPM.
Flow Control Valve Available.

Y-2 SELF CLOSING

FROST PROOF YARD HYDRANT FEATURES/BENEFITS

Several important improvements have been made on the self-closing hydrant over the years. These improvements and the basic design are why we believe the self-closing is the best hydrant of its type in the industry.

- * (1) **SELF-CLOSING** Stainless steel spring and water pressure closes hydrant.
BENEFIT: Hydrant shuts off so water is not wasted. Ideal for public use.
- (2) **LOCKS OPEN OR CLOSED** Simply push lock button to lock hydrant open or closed.
BENEFIT: Hydrant can be locked to restrict use if needed.
- (3) **BRASS OR NO LEAD BRASS HOSE ADAPTER** Heavy-duty hose adapter for standard 3/4" hose coupling. Interchangeable with head plug for easier plumbing attachment when needed.
BENEFIT: Standard garden hose thread in long life non-corrosive brass or no lead brass.
- (4) **EXTRA THICK WALLED HEAD CASTING** greatly reduces breakage and insures longer life.
BENEFIT: Withstands years of use and rough service.
- * (5) **HEAD PLUG** can be installed in front of head casting simply by changing places with hose adapter.
BENEFIT: Provides easier plumbing attachment when needed.
- (6) **CAP SCREWS** Hydrants manufactured after 11/1/77 will have 3/8" x 5/16" self-locking socket head cap screws, and assembled with a locking sealant.
BENEFIT: Provides strong hold for hydrant head to pipe for years of service.
- (7) **HIGH QUALITY GALVANIZED PIPE** 1" extra heavy pipe on outside and galvanized pipe on inside.
BENEFIT: Corrosion protected for long life.
- (8) **NO EXPOSED THREADS** on inside pipe or outside pipe.
BENEFIT: No uncoated metal to rust for longest life.
- * (9) **CAST IRON BODY WITH POLISHED BRASS SLEEVE** for plunger seals to travel in, and pressed into heavy cast iron valve body for strength and economy.
BENEFIT: Economical, smoother sealing surface for plunger seals.
- * (10) **SOLID BRASS PLUNGER** Hydrants manufactured after 11/1/78 will have (3) ethylene propylene quad ring seals, self-lubricating and never come out of adjustment, have longer life, and withstand higher pressures.
BENEFIT: Longest operating life plunger of its type.
- * (11) **SWIVEL PARTS** permit withdrawal of all moving parts without digging up hydrant. A 3/16" Hex Key will allow disassembly of hydrant by simply removing two cap screws and pull up inside pipe with plunger for inspection.
BENEFIT: Very easy to repair, simple reliable design.

*EXCLUSIVE MERRILL QUALITY FEATURES

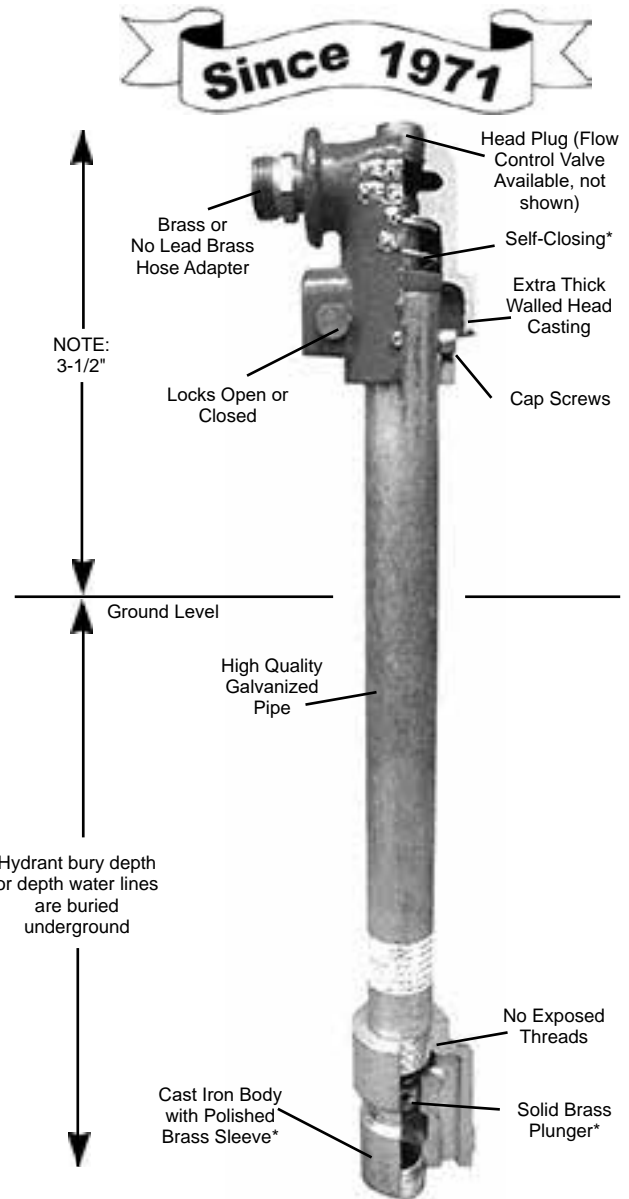

Y-2 FLOW RATES

WATER SYSTEM PRESSURE	STD. 3/4" GALLONS PER MINUTE (GPM)										
	0	5	10	15	20	25	30	35	40	45	50
20 PSI	13.6 GPM @ 20 PSI										
30 PSI	15.2 GPM @ 30 PSI										
40 PSI	18.8 GPM @ 40 PSI										
60 PSI	23 GPM @ 60 PSI										

U.S. Patent No. 3,523,549 3,672,392 222,459
Recommended Maximum Operating Pressure 60 psi
 (Due to Self-Closing Design)
 Most common submersible pump 1/2 hp, output 10 GPM.
 Flow Control Valve Available.

☆ No Lead

❖ CA. Certified

Y-1 AND Y-2 SELF CLOSING

Y-1 Specifications

Inlet: 3/4" NPT Outlet: 3/4" Brass or No Lead Brass Hose Thread

Self-Closing can be locked open or closed

Brass Plunger with three quad ring seals

1" Galvanized Pipe & Galvanized Internal Pipe

Outlet stands 27" above ground level

Y-1 SELF CLOSING - STANDARD 3/4" INLET

Order No.	UPC Bar Code (Qty. 1)	Inlet x Length	Overall Length	Approx. Wt./Lbs.
☆Y17501	6 42367 03038 4	3/4" x 1' Bury	40.3"	13.16
☆Y17502	6 42367 03039 1	3/4" x 2' Bury	52.3"	15.70
☆Y17503	6 42367 03040 7	3/4" x 3' Bury	64.3"	18.24
☆Y17504	6 42367 03041 4	3/4" x 4' Bury	76.3"	20.78
☆Y17505	6 42367 03042 1	3/4" x 5' Bury	88.3"	23.32
☆Y17506	6 42367 03043 8	3/4" x 6' Bury	100.3"	25.86
☆Y17507	6 42367 03044 5	3/4" x 7' Bury	112.3"	28.40
☆Y17508	6 42367 03045 2	3/4" x 8' Bury	124.3"	30.94
☆Y17510	6 42367 03046 9	3/4" x 10' Bury	148.3"	33.48

Y-2 Specifications

Inlet: 3/4" NPT Outlet: 3/4" Brass or No Lead Brass Hose Thread

Self-Closing can be locked open or closed

Brass Plunger with three quad ring seals

1" Galvanized Pipe & Galvanized Internal Pipe

Outlet stands 3-1/2" above ground level

Y-2 SELF-CLOSING STANDARD 3/4" INLET

Order No.	UPC Bar Code (Qty. 1)	Inlet Size x Length	Overall Length	Approx. Wt./Lbs.
☆Y27502	6 42367 03054 4	3/4" x 2' Bury	29"	10.10
☆Y27503	6 42367 03055 1	3/4" x 3' Bury	41"	12.64
☆Y27504	6 42367 03056 8	3/4" x 4' Bury	53"	15.18
☆Y27505	6 42367 03057 5	3/4" x 5' Bury	65"	17.72
☆Y27506	6 42367 03058 2	3/4" x 6' Bury	77"	20.26
☆Y27507	6 42367 03059 9	3/4" x 7' Bury	89"	22.80
☆Y27508	6 42367 03060 5	3/4" x 8' Bury	101"	25.34
☆Y27510	6 42367 03061 2	3/4" x 10' Bury	125"	27.88

Y-1 AND Y-2 PARTS LIST

Order No.	UPC Bar Code (Qty. 1)	Parts Description
Y-1	6 42367 03035 3	Head Complete - Part No. Y-2A, Y-4, G-6, 1/8x3/8MDK
Y-2	6 42367 03052 0	Head Complete - Part No. Y-2A, Y-4, G-6, 1/8x3/8MDK
Y-2A	6 42367 03062 9	Lock Pin
1/8x3/8MDK	6 42367 00051 6	Roll Pin
Y-3	6 42367 03068 1	Compression Spring
☆A1-1/4C	6 42367 10014 8	Spring Retainer
Y-4	6 42367 03089 6	Countersunk Head Plug
G-6	6 42367 01543 5	Brass Hose Adapter
☆GNL-6	6 42367 41048 3	No Lead Hose Adapter
Y-7	6 42367 03099 5	1/4" x 1/4" Socket Head Cap Screw (used before 11/1/77)
Y-8	6 42367 03100 8	3/8" x 5/16" Self-Locking Socket Head Cap Screw (used after 11/1/77)
Y-20	6 42367 03053 7	Flow Control Valve (Optional)
☆Y-35		Inside Galvanized Pipe
☆Y-37		1" Galvanized Pipe
Y-40	6 42367 03090 2	Valve Body with Brass Insert
Y-41B	6 42367 03096 4	Plunger with Seals
Y-45X	6 42367 03098 8	Quad Ring Seals (used after 11/1/78)
☆A-250	6 42367 07720 4	Container of Silicone Lube

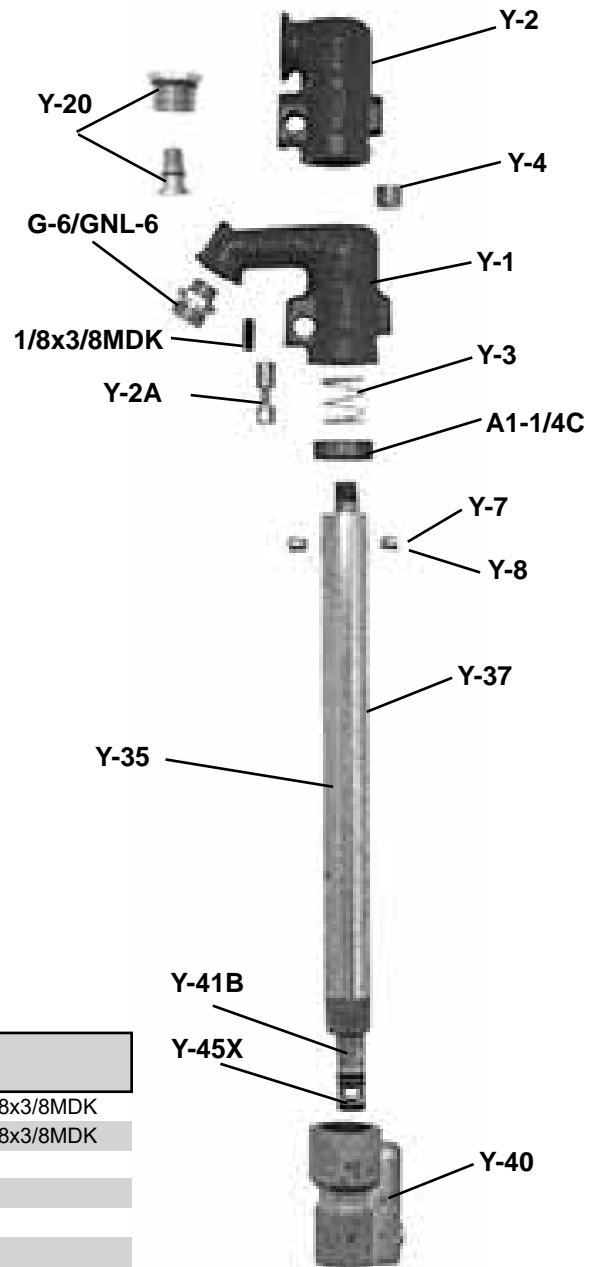

HYDRANTS AVAILABLE WITH OPTIONAL No Lead Brass Vacuum Breakers

• ASSE-IAPMO Code approved and marked.

- ❖BVBADNL75 3/4" Hose - Brass Finish - AUTO DRAIN - No Lead
- ☆BVBNL75M 3/4" Hose - Brass Finish - MANUAL DRAIN - No Lead



BVBADNL75



BVBNL75M